



 LORENZOLINE

**150BC**

Rolling Roof System

# 150BC

## BIOCLIMATIC SYSTEM BIOKLİMATİK SİSTEM



- Provides natural light thanks to aluminium and glass lamellas combination.
- Quicker installation thanks to practical connection accessories.
- More durability thanks to reinforced lamella covers.
- Longer life thanks to stainless steel fasteners.
- Bioclimatic and Rolling Roofs can be built with the same profiles.
- Special gutter solutions for water sealing.

- Alüminyum lamel ve cam lamel kombinasyonu ile doğal ışık imkanı,
- Pratik birleşim aksesuarları sayesinde daha hızlı montaj imkanı.
- Güçlendirilmiş lamel kapakları sayesinde daha sağlam,
- Paslanmaz bağlantı elemanlarıyla sayesinde daha uzun ömürlü,
- Aynı profillerle Bioclimatic ve Rolling Roof yapabilme,
- Su sızdırmazlık için özel oluk çözümleri,



PROFILES  
PROFILLER

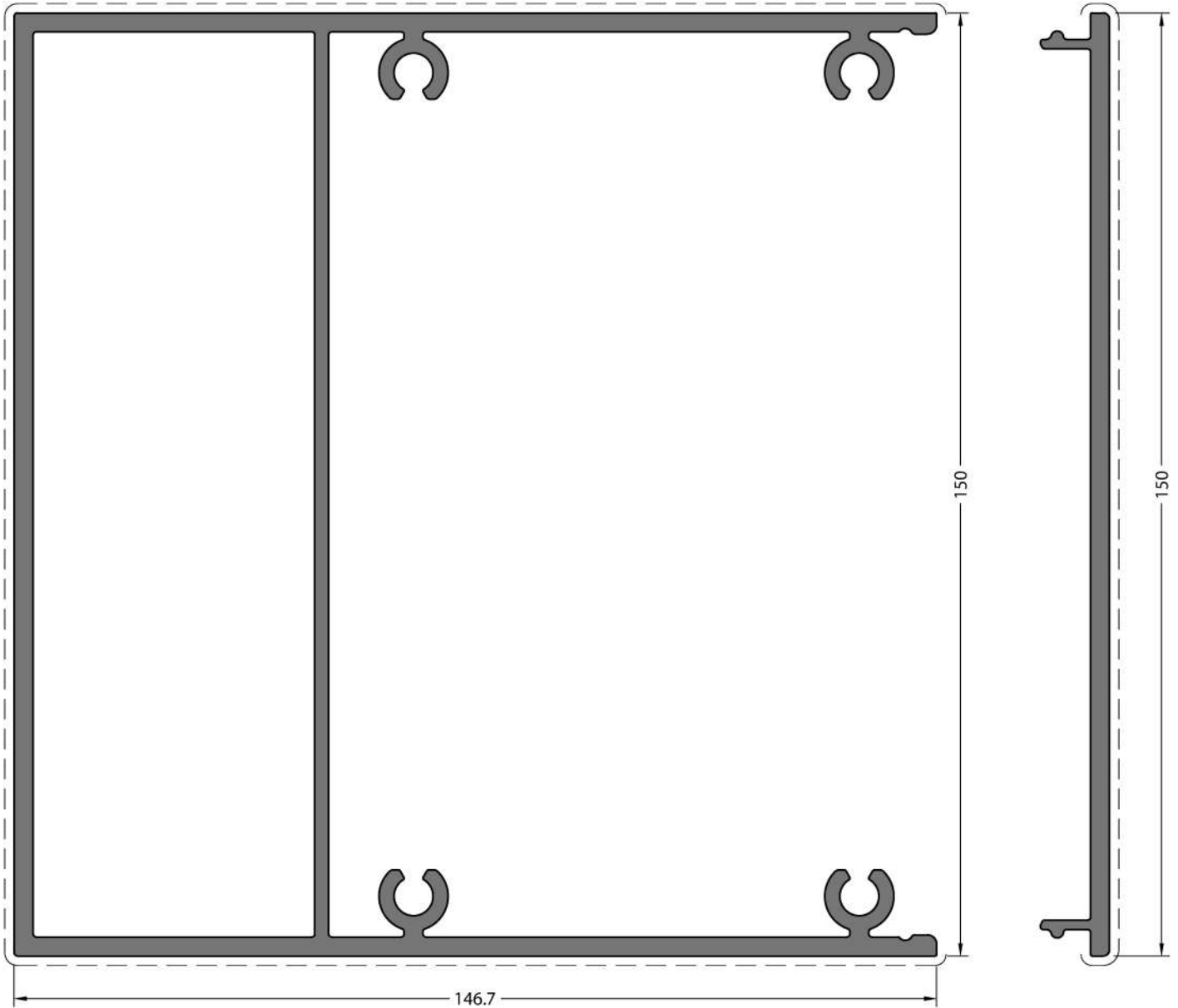

CODE / KOD

**150BC-101-00**

**THEORETICAL WEIGHT**  
TEORİK AĞIRLIK ( kg/m )

**5.108**

CODE / KOD

**150BC-102-00**

**THEORETICAL WEIGHT**  
TEORİK AĞIRLIK ( kg/m )

**1.291**

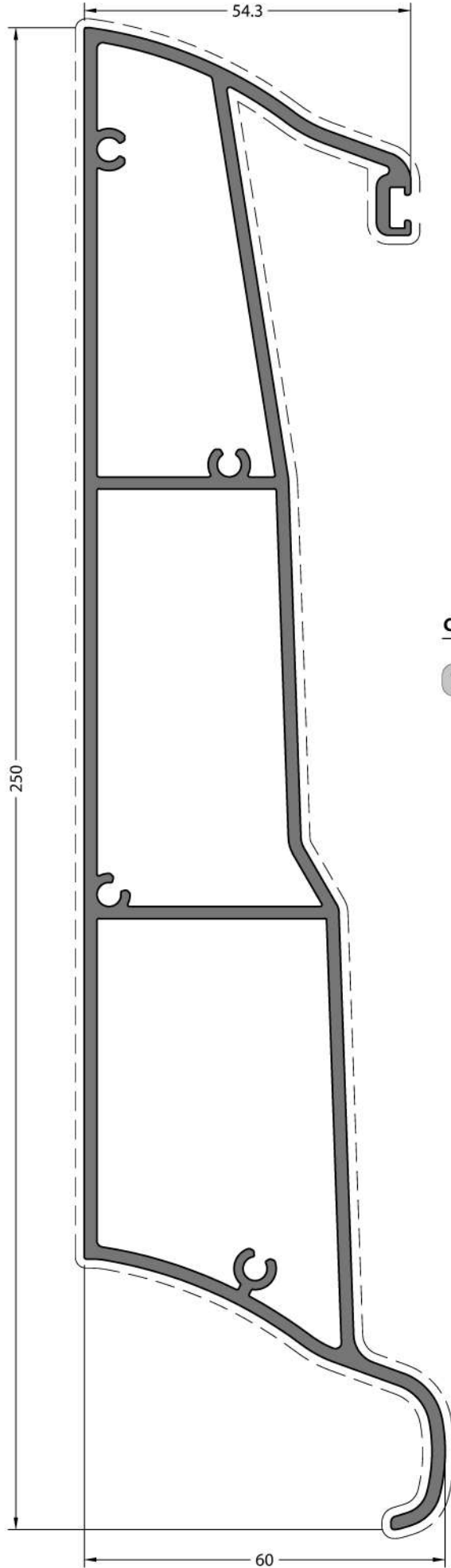

CODE / KOD

150BC-201-00

THEORETICAL WEIGHT

TEORİK AĞIRLIK ( kg/m )

3.850

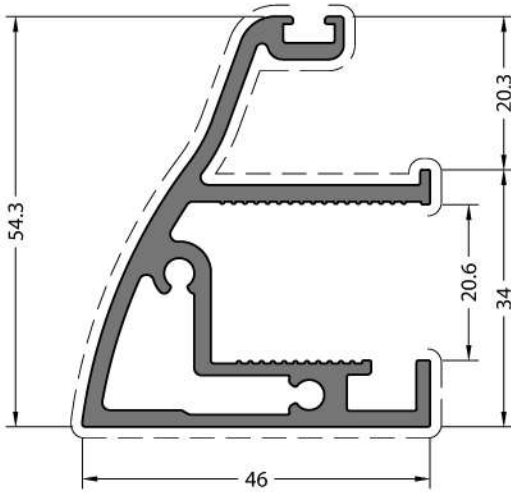

**CODE / KOD**  
**150BC-211-00**

**THEORETICAL WEIGHT**  
TEORİK AĞIRLIK ( kg/m )  
**1.247**

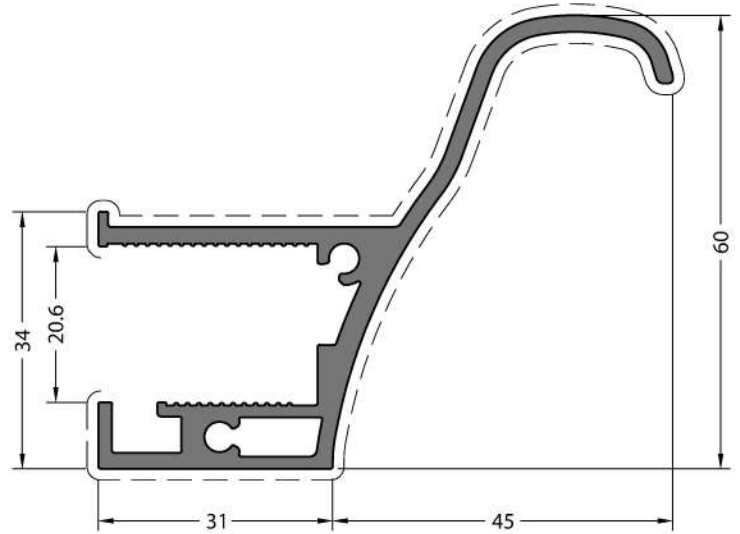

**CODE / KOD**  
**150BC-212-00**

**THEORETICAL WEIGHT**  
TEORİK AĞIRLIK ( kg/m )  
**1.233**

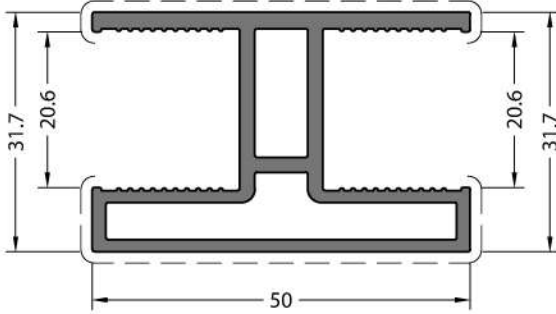

**CODE / KOD**  
**150BC-213-00**

**THEORETICAL WEIGHT**  
TEORİK AĞIRLIK ( kg/m )  
**1.032**

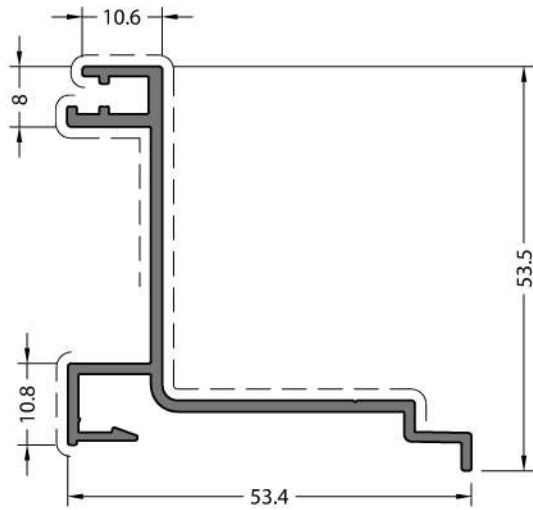

**CODE / KOD**  
**150BC-503-00**

**THEORETICAL WEIGHT**  
TEORİK AĞIRLIK ( kg/m )  
**0.567**

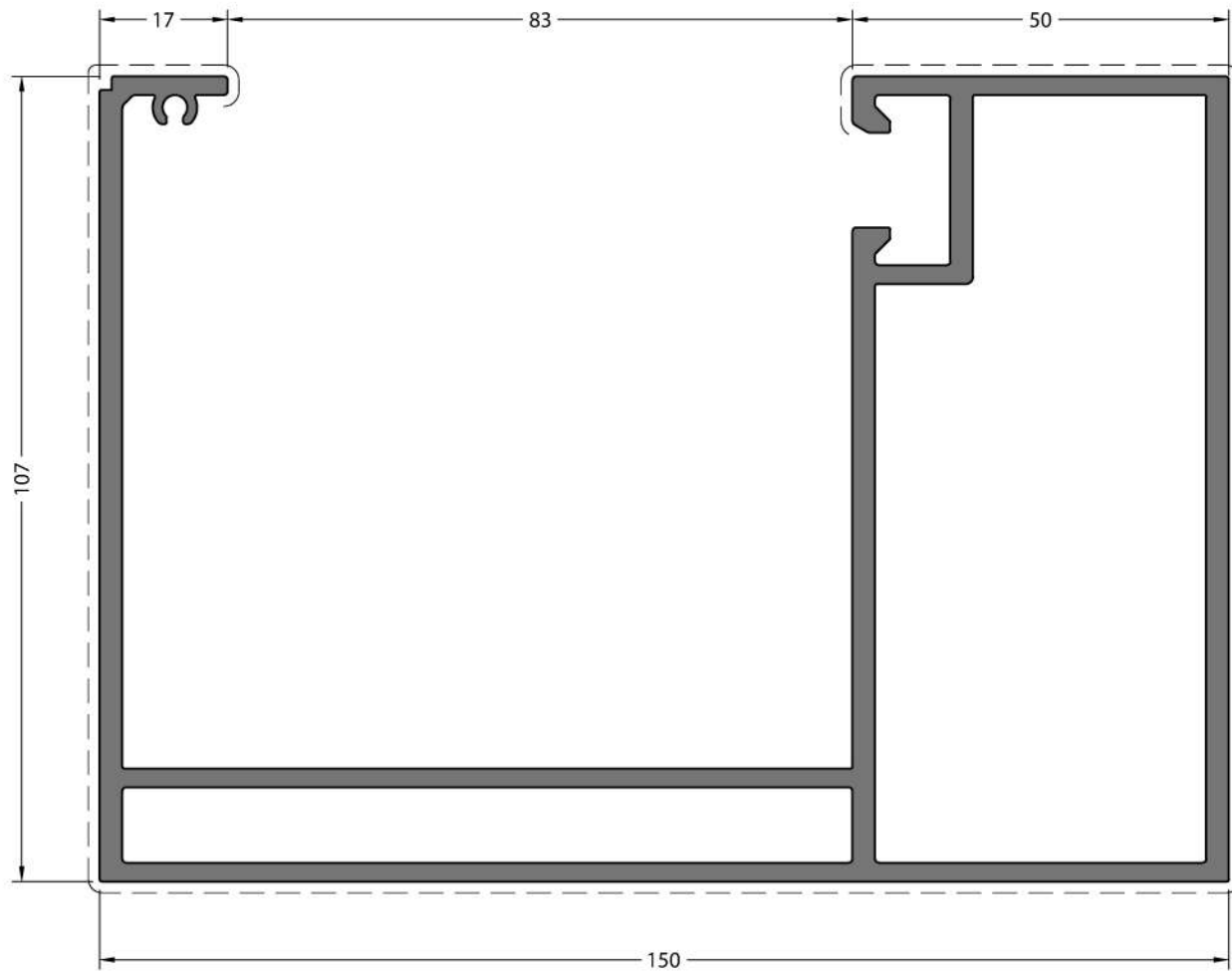

**CODE / KOD**

**150BC-301-00**

**THEORETICAL WEIGHT**

TEORİK AĞIRLIK ( kg/m )

**4.815**

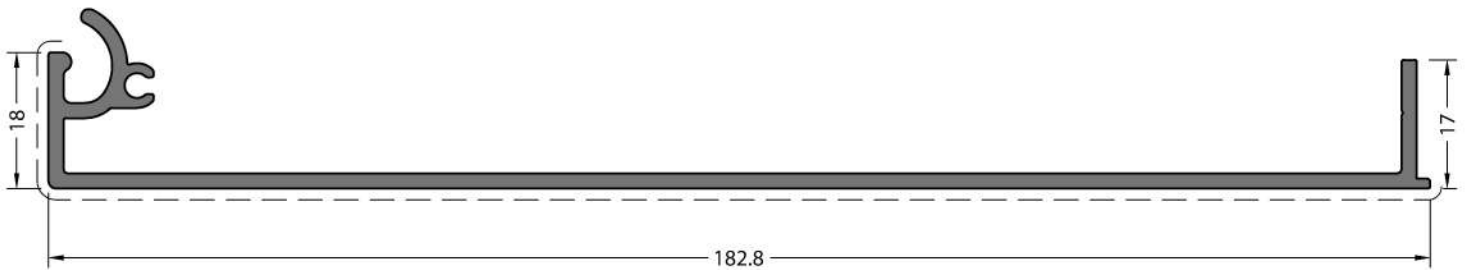

**CODE / KOD**

**150BC-302-00**

**THEORETICAL WEIGHT**

TEORİK AĞIRLIK ( kg/m )

**1.299**

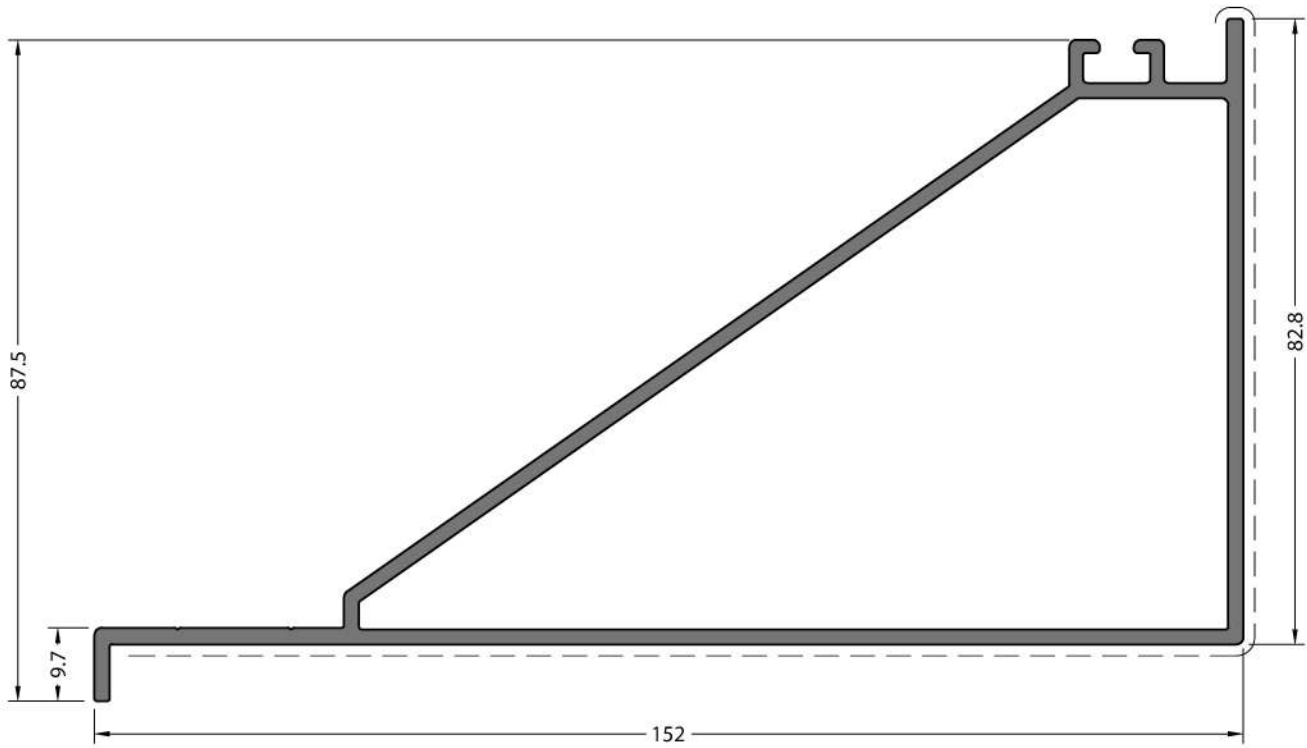

**CODE / KOD**

**150BC-303-00**

**THEORETICAL WEIGHT**

TEORİK AĞIRLIK ( kg/m )

**2.157**

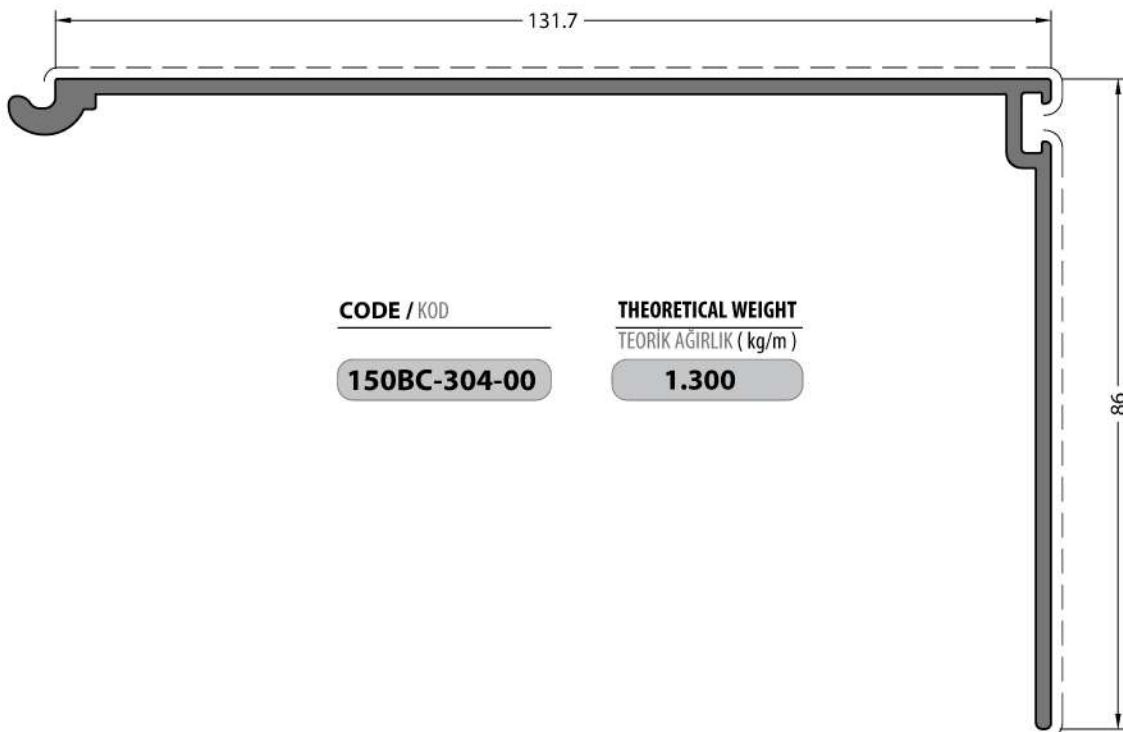

**CODE / KOD**

**150BC-304-00**

**THEORETICAL WEIGHT**

TEORİK AĞIRLIK ( kg/m )

**1.300**

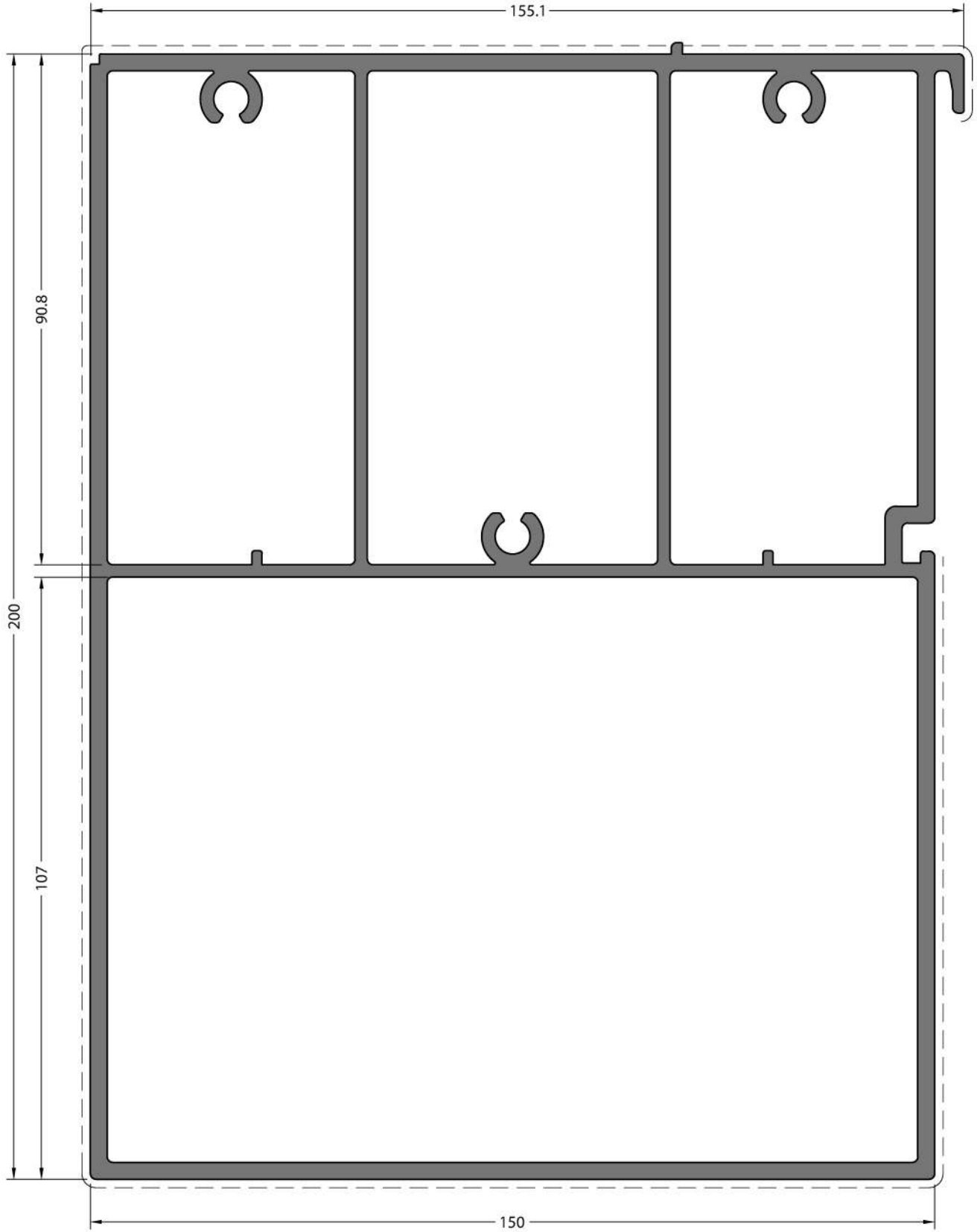

**CODE / KOD**

**150BC-401-00**

**THEORETICAL WEIGHT**

TEORİK AĞIRLIK ( kg/m )

**8.080**

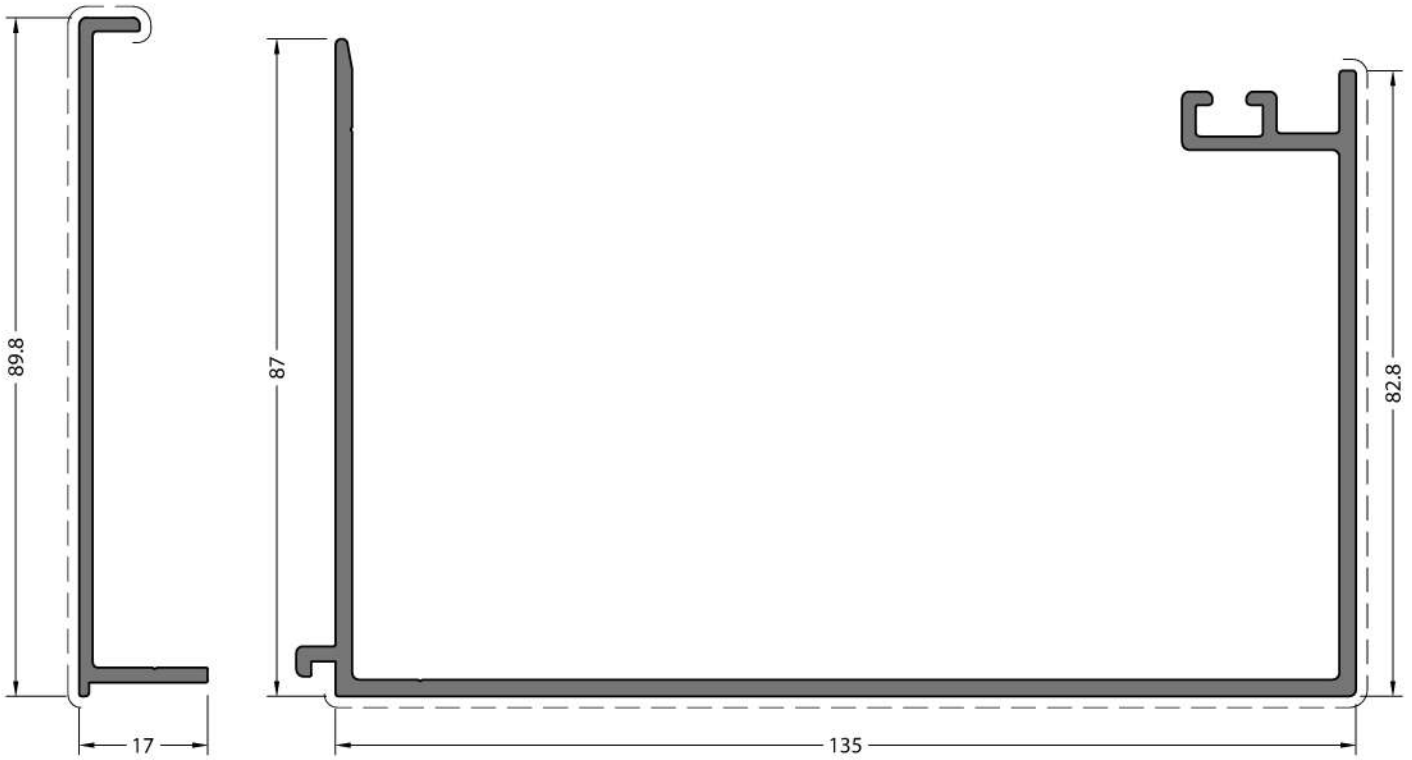

**CODE / KOD**

**150BC-402-00**

**THEORETICAL WEIGHT**  
TEORİK AĞIRLIK ( kg/m )

**1.291**

**CODE / KOD**

**150BC-403-00**

**THEORETICAL WEIGHT**  
TEORİK AĞIRLIK ( kg/m )

**2.004**

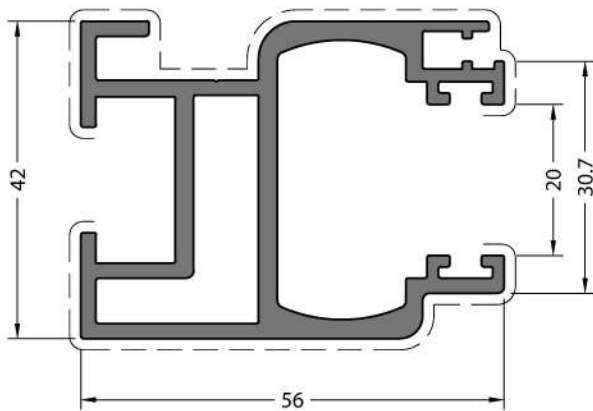

**CODE / KOD**

**150BC-501-00**

**THEORETICAL WEIGHT**  
TEORİK AĞIRLIK ( kg/m )

**1.507**

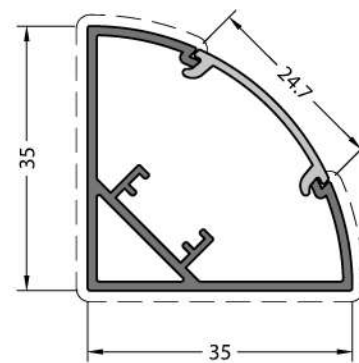

**CODE / KOD**

**07-126-00**

**THEORETICAL WEIGHT**  
TEORİK AĞIRLIK ( kg/m )

**0.419**

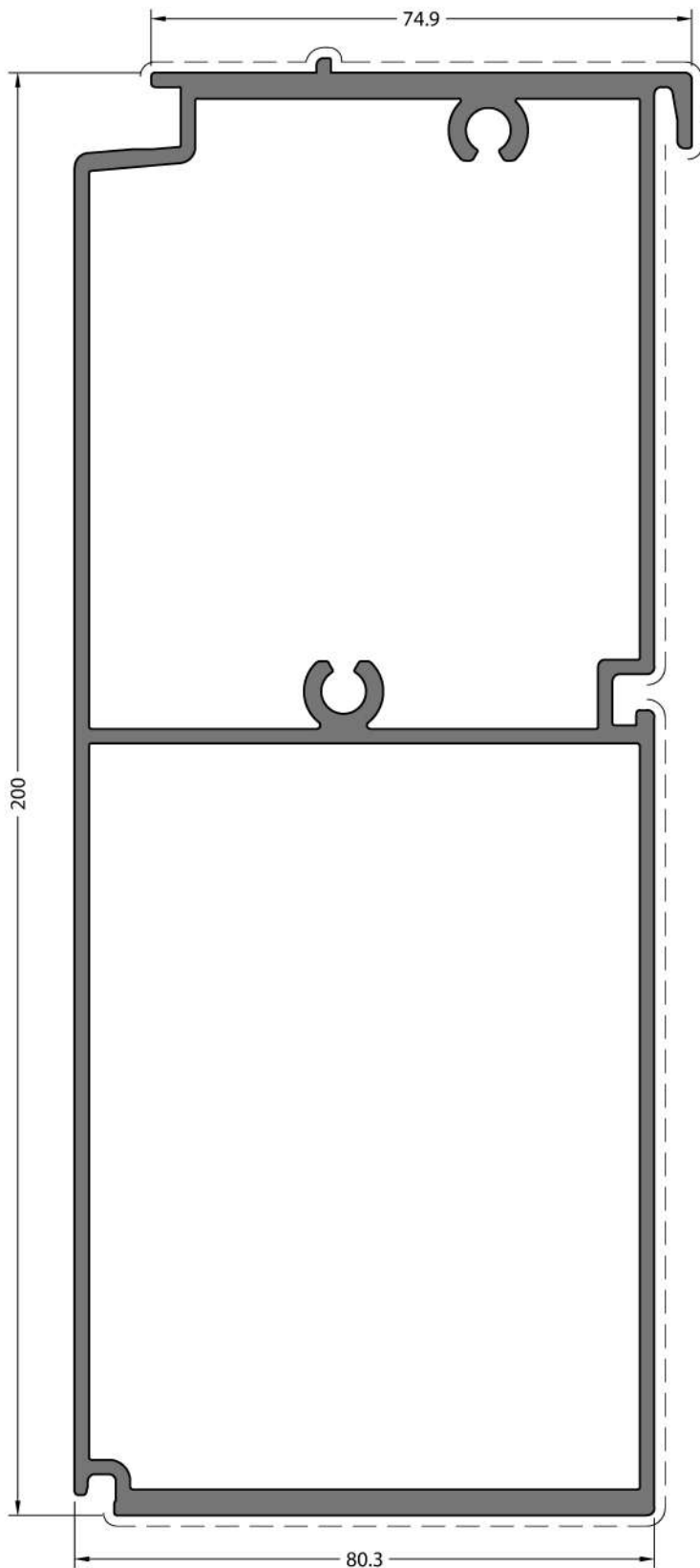

CODE / KOD

**150BC-411-00**

**THEORETICAL WEIGHT**  
TEORİK AĞIRLIK (kg/m)

**4.425**

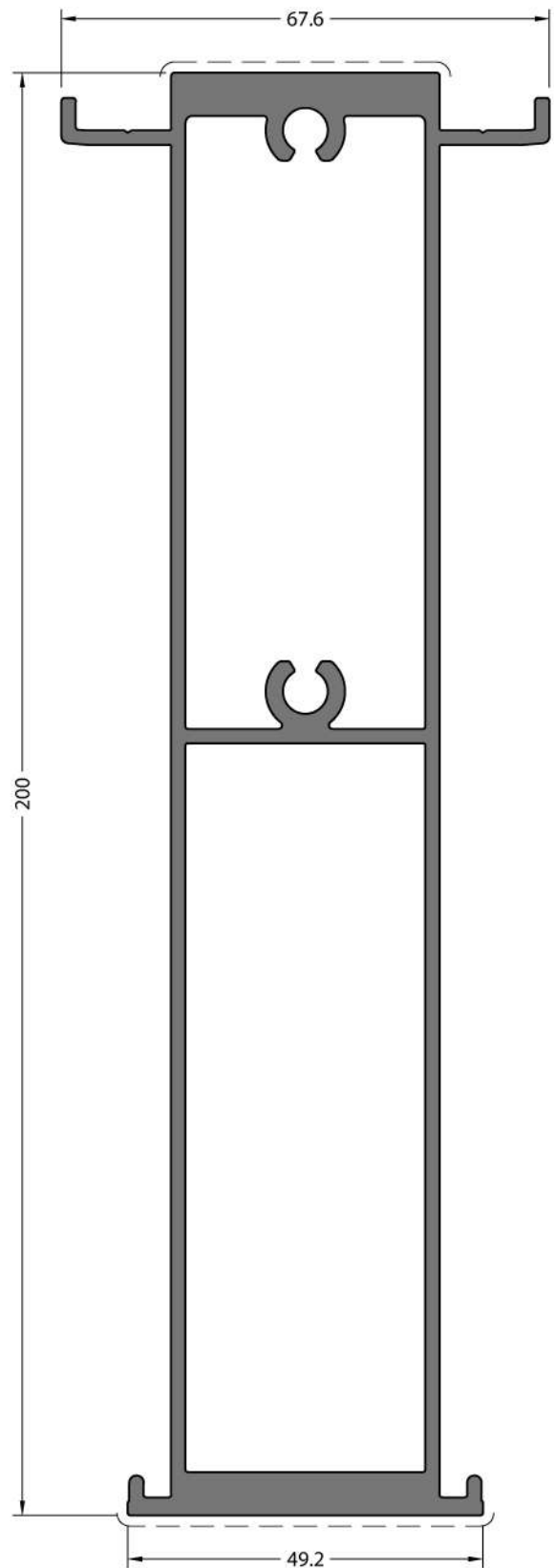

CODE / KOD

**150BC-413-00**

**THEORETICAL WEIGHT**  
TEORİK AĞIRLIK (kg/m)

**3.957**

DETAILS  
DETAYLAR

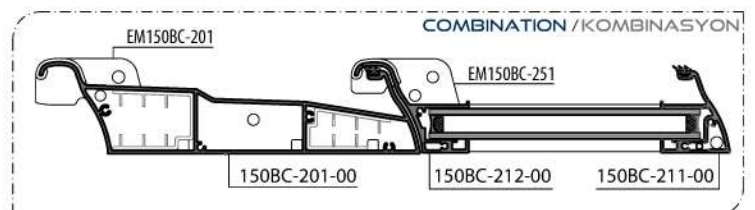
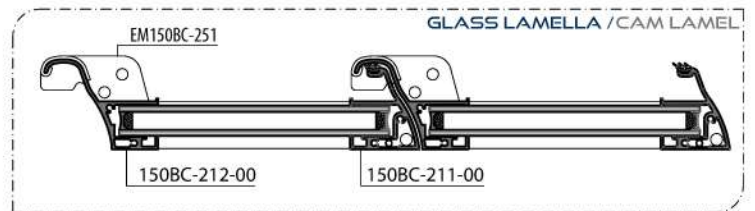
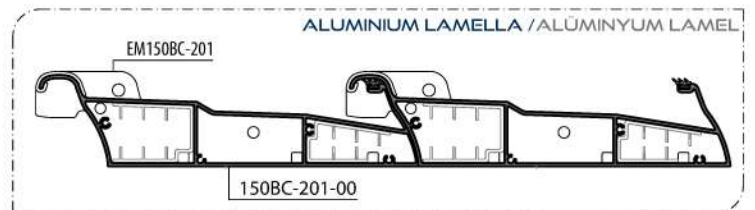
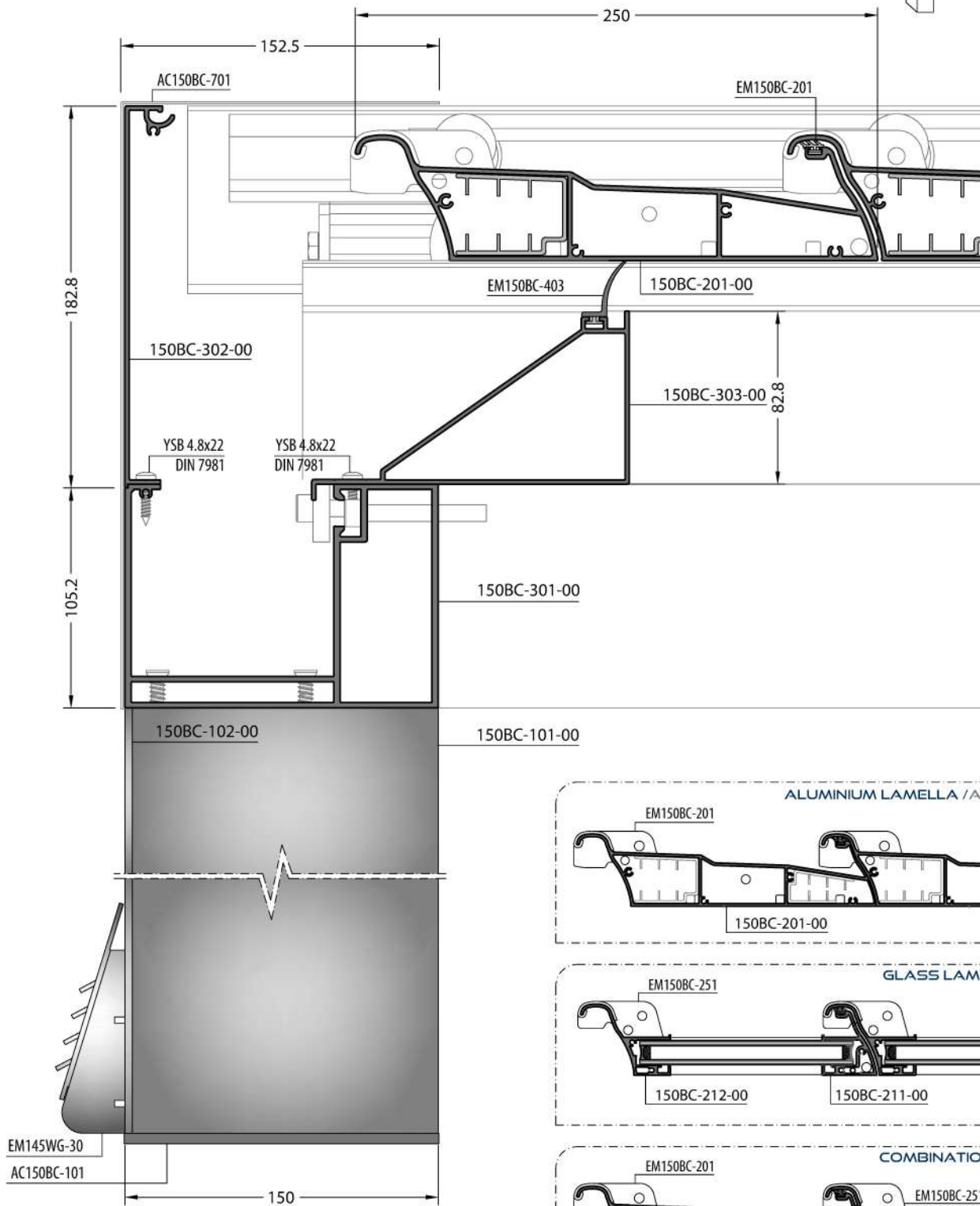
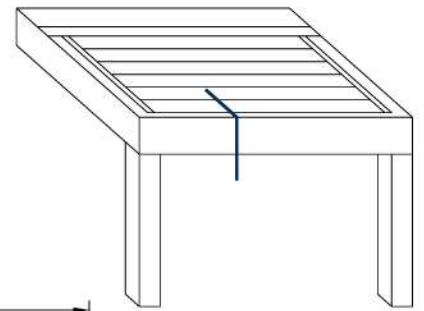

No scaled / Ölçeksiz

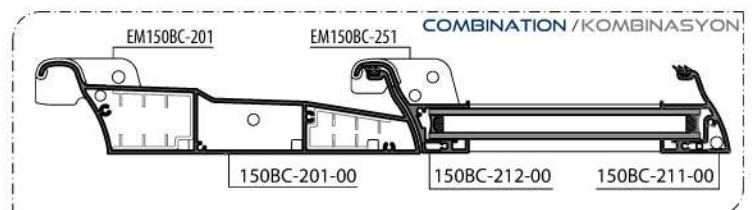
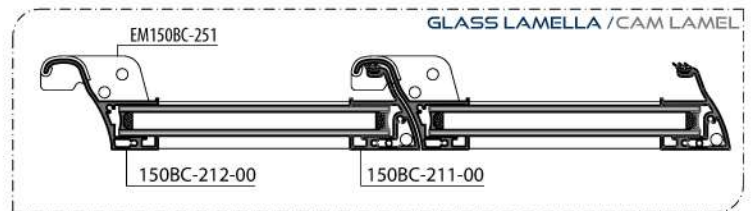
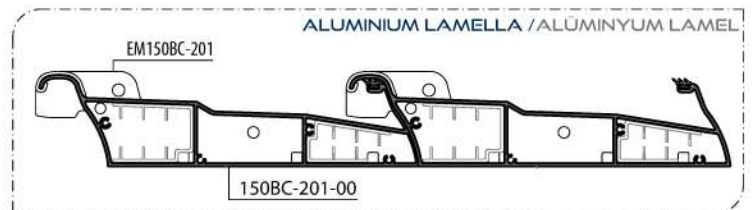
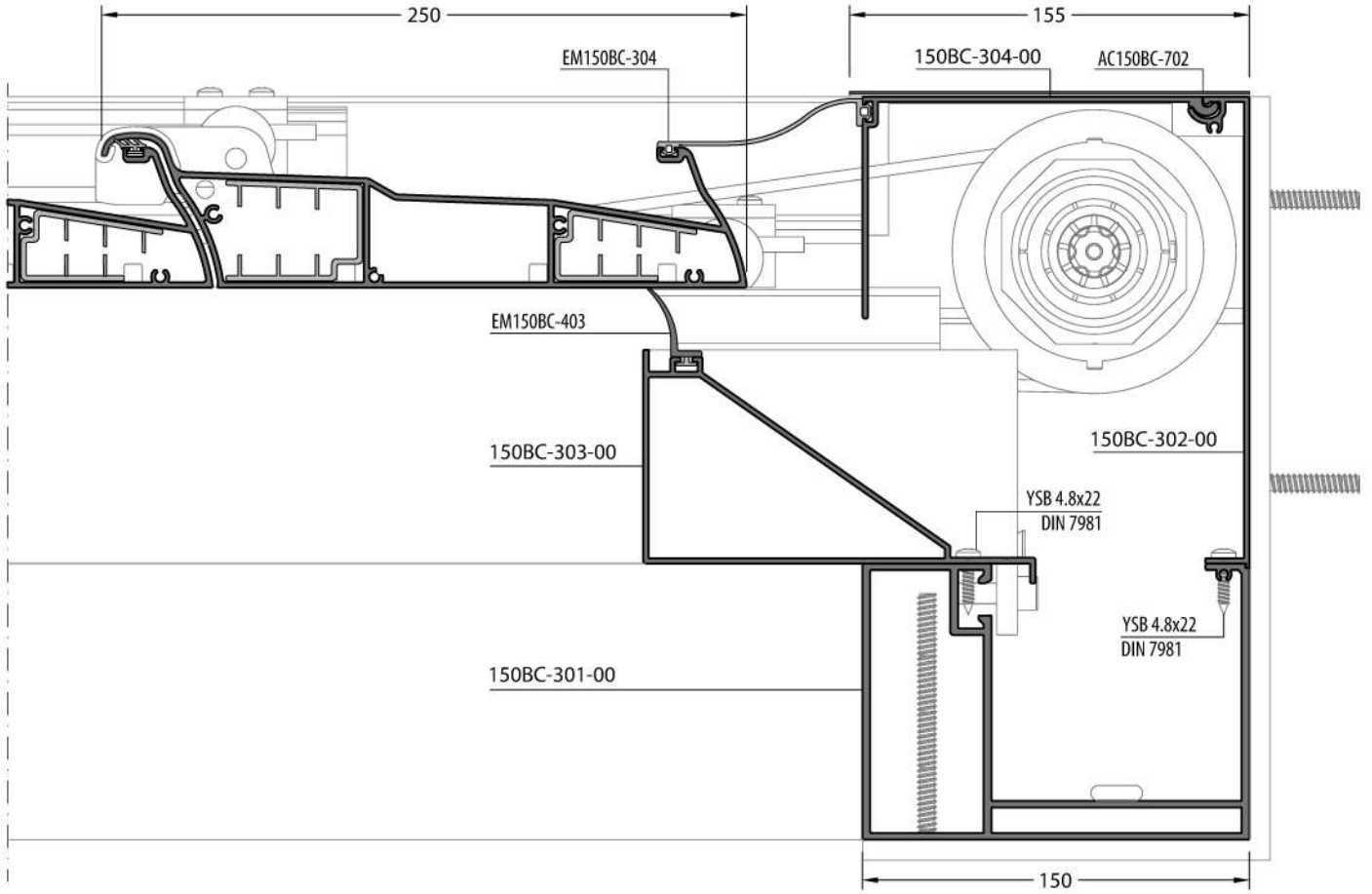
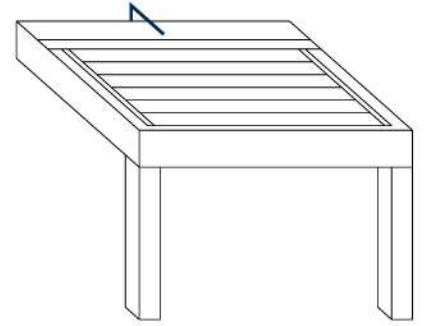

No scaled / Ölçeksiz

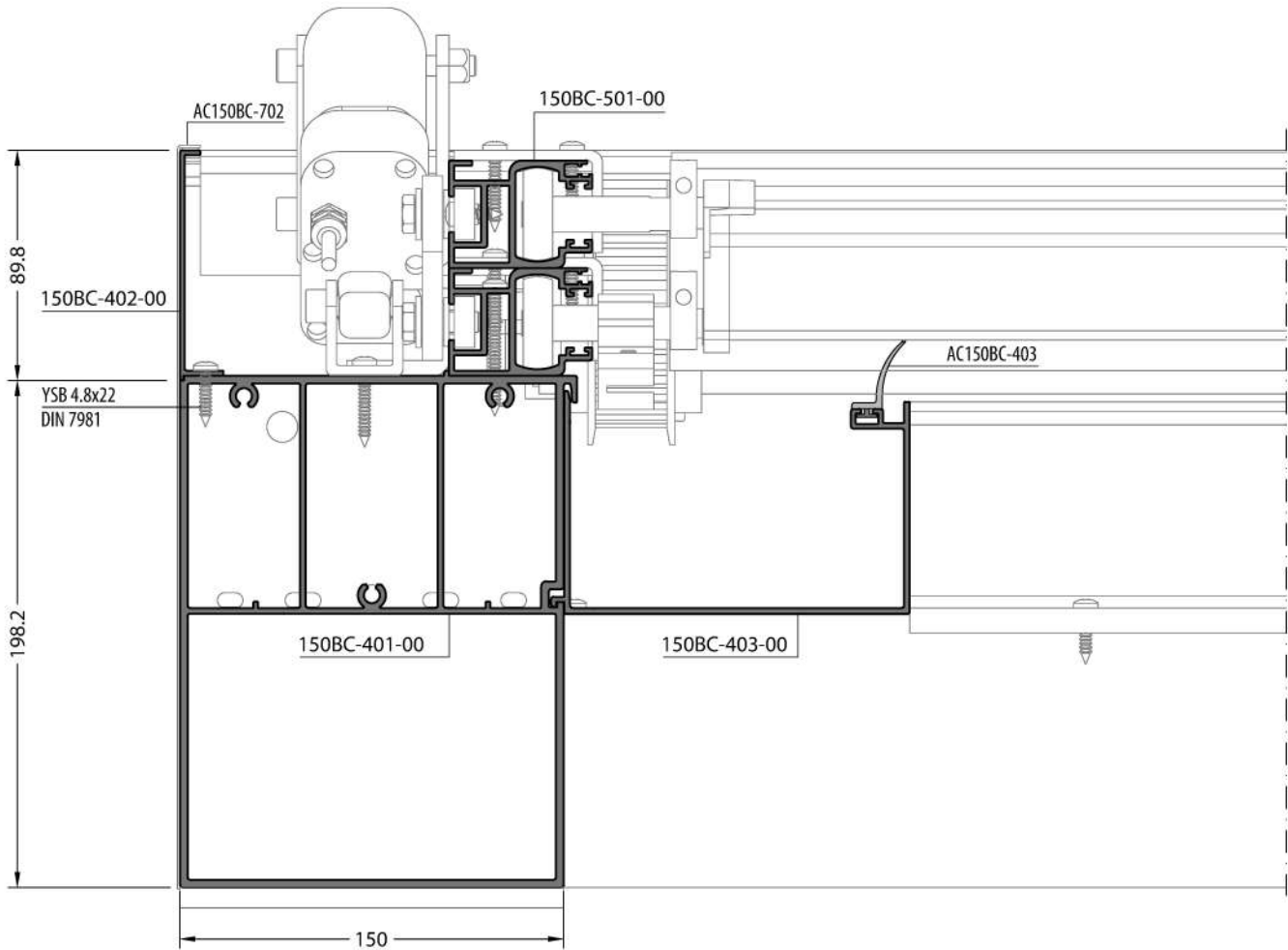
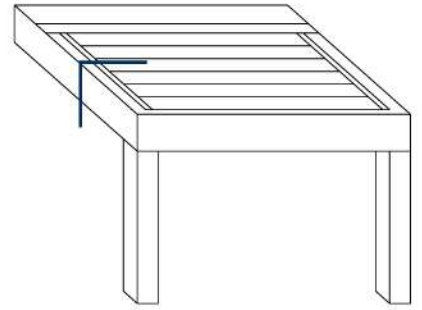

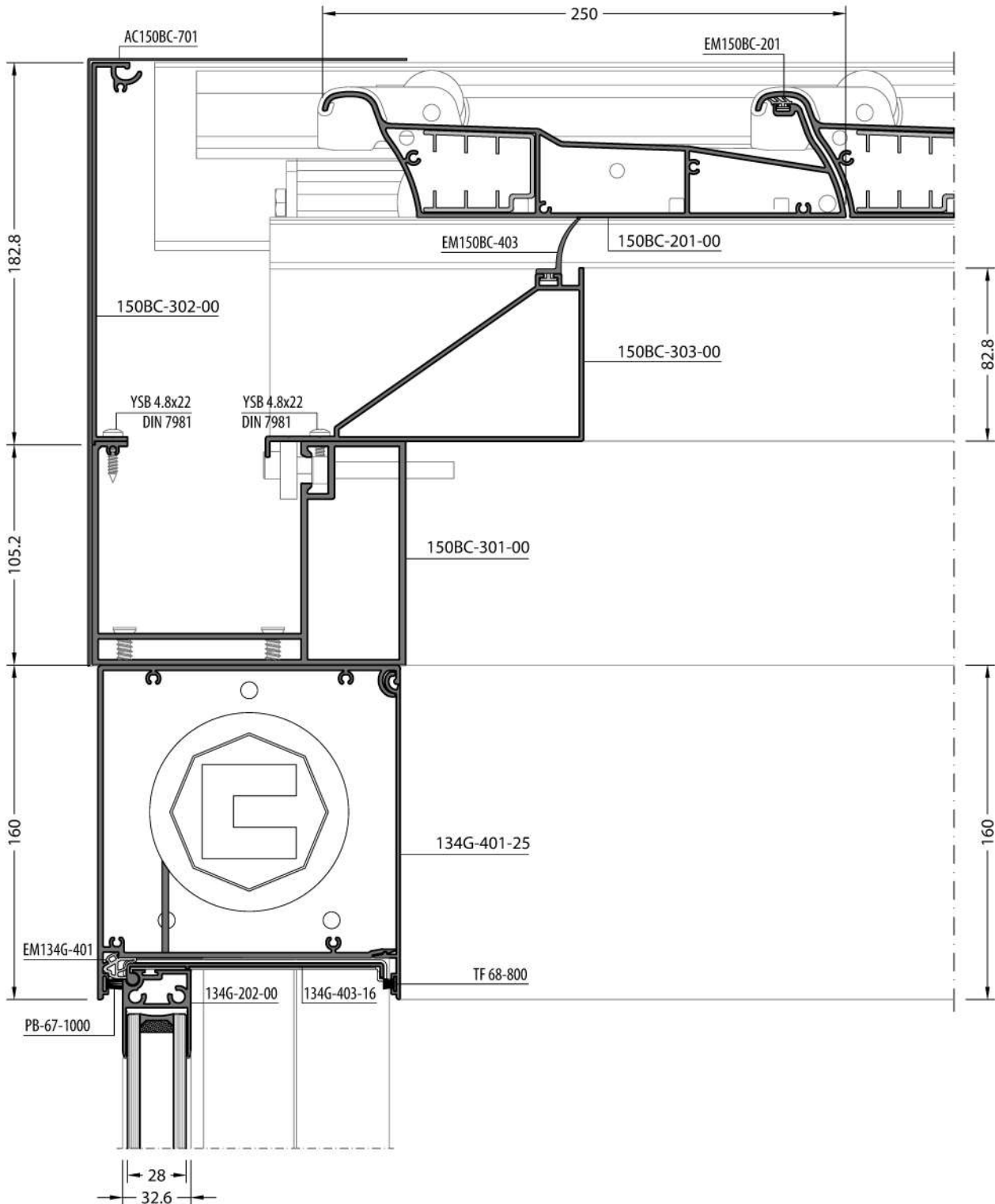
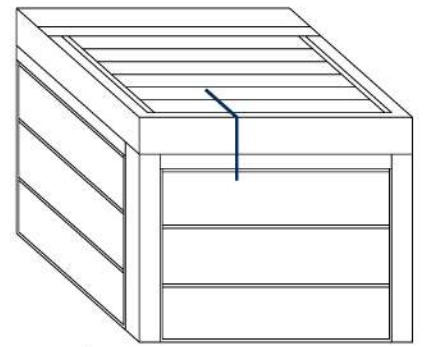

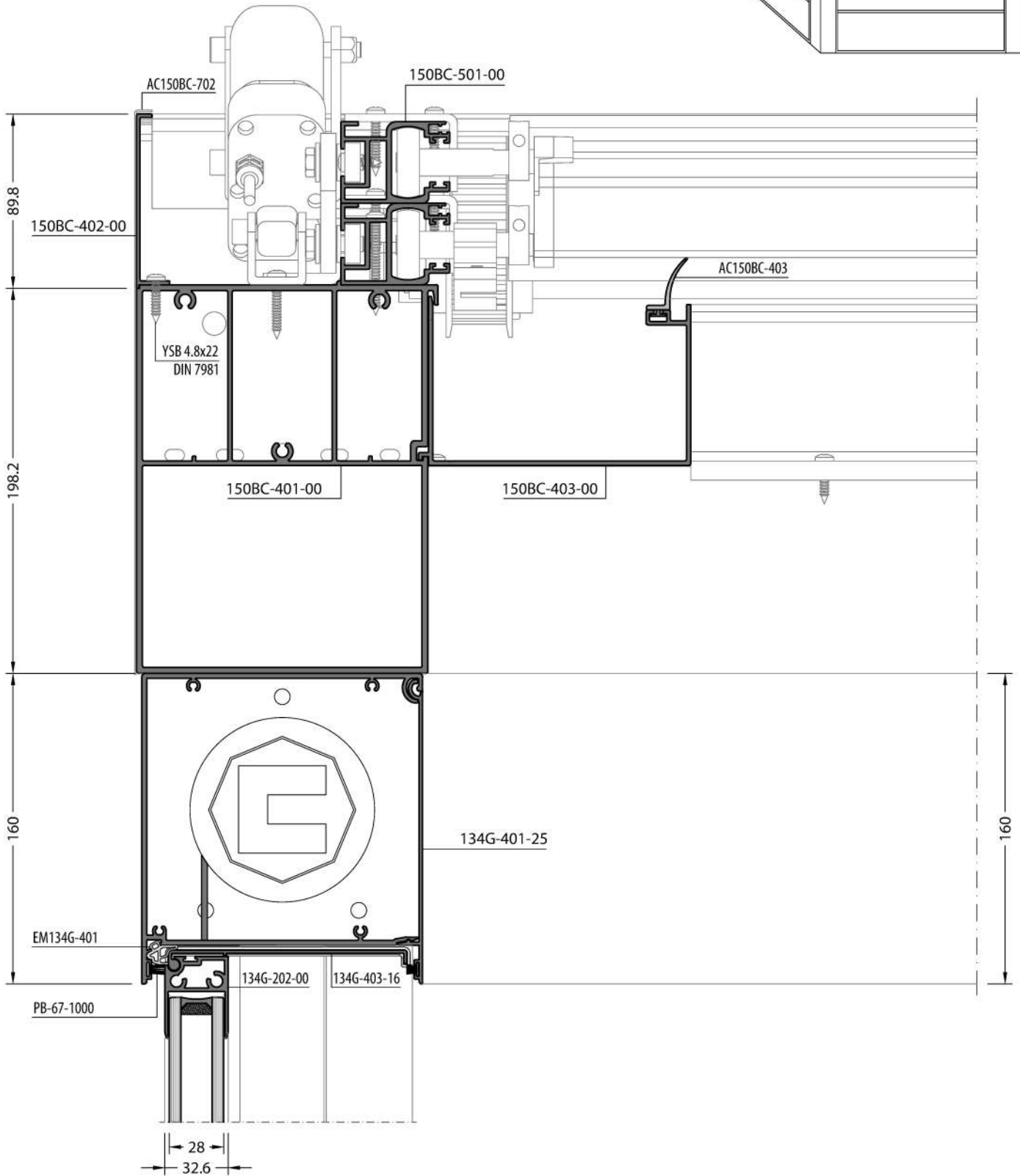
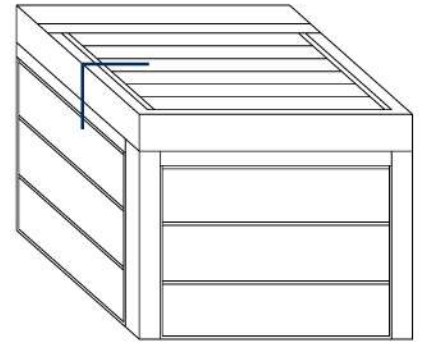

No scaled / Ölçeksiz

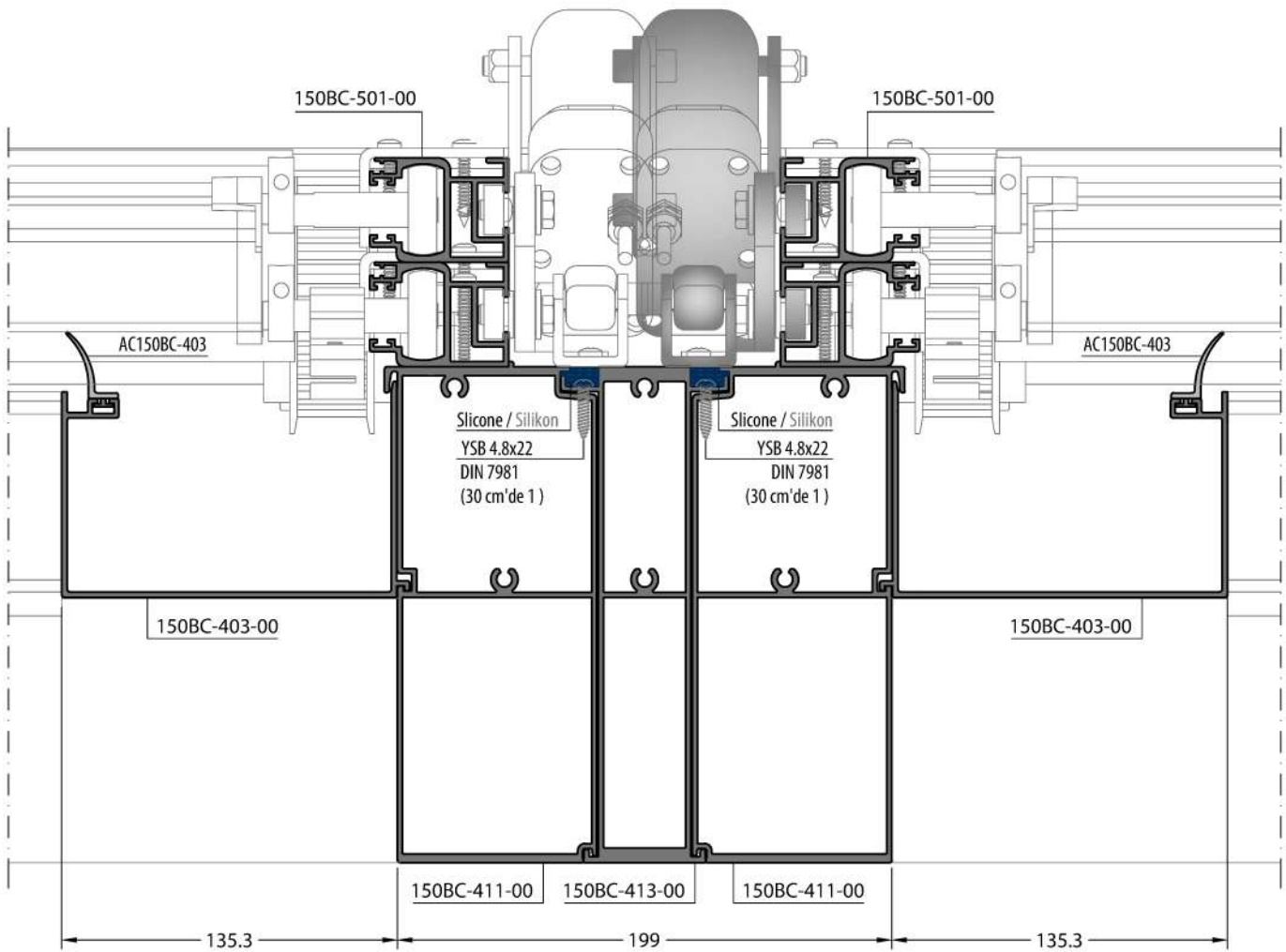
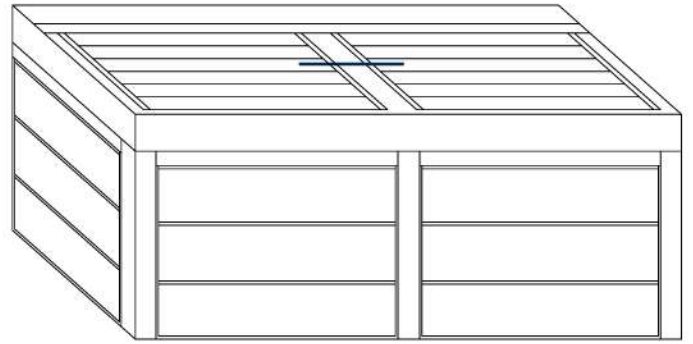

ACCESSORIES  
AKSESUARLAR







**ACCESSORIES / AKSESUARLAR**

PACKAGE CODE PAKET KODU	PICTURE / RESİM	DESCRIPTION AÇIKLAMA	PACKAGE CODE PAKET KODU	PICTURE / RESİM	DESCRIPTION AÇIKLAMA
<b>AC150BC-201</b>		<b>LAMELLA CAP SIDE SET</b> LAMEL YAN KAPAK TAKIMI	<b>AC150BC-611</b>		<b>MIDDLE STEEL BRACKET</b> ORTA ÇELİK BRAKET
<b>AC150BC-251</b>		<b>GLASS LAMELLA CAP SIDE SET</b> CAM LAMEL YAN KAPAK TAKIMI	<b>AC150BC-261</b>		<b>LAMELLA SUPPORT WEDGE</b> LAMEL DESTEK TAKOZU
<b>AC150BC-202</b>		<b>PULLEY</b> RULMAN	<b>AC150BC-510</b>		<b>TRIGER CONNECTION PART</b> TRIGER BİRLEŞİM ELEMANI
<b>AC150BC-221</b>		<b>FRICTION HINGE BIOCLIMATIC</b> MAKAS BİOKLİMATİK	<b>AC150BC-231</b>		<b>ROPE RING</b> HALAT YÜZÜĞÜ
<b>AC150BC-401</b>		<b>MAIN RAIL BRACKET</b> ANA RAY MONTAJ PLAKASI	<b>AC150BC-232</b>		<b>COATED STAINLESS ROPE</b> KAPALAMALI PASLANMAZ HALAT
<b>AC150BC-101</b>		<b>POST BRACKET</b> KOLON ANKRAJİ	<b>AC150BC-233</b>		<b>ALUMINUM WASHER</b> ALÜMİNYUM PUL
<b>AC150BC-502</b>		<b>TRIGER TENSION SET</b> TRIGER GERGİ TAKIMI	<b>AC150BC-570</b>		<b>WALL BRACKET</b> DUVAR ANKRAJİ
<b>AC150BC-550</b>		<b>LAMELLA LOCK SET</b> LAMEL KİTLEME BRAKETİ	<b>AC150BC-602</b>		<b>80x160x6mm STEEL PROFILE</b> ÇELİK PROFİL

**ACCESSORIES / AKSESUARLAR**

PACKAGE CODE PAKET KODU	PICTURE / RESİM	DESCRIPTION AÇIKLAMA	PACKAGE CODE PAKET KODU	PICTURE / RESİM	DESCRIPTION AÇIKLAMA
AC150BC-501-40		<b>BRUSH</b> FİRÇA	AC150BC-582		<b>TUBULAR MOTOR WITHOUT RECIEVER</b> ALICILI TÜP MOTOR
AC07-126A		<b>LED PROFILE DIFFUSER</b> LED PROFİL DİFÜZÖRÜ	AC150BC-584		<b>TUBE HEAD</b> BORU BAŞI
AC07-126B		<b>LED PROFILE CORNER</b> LED PROFİL KÖŞE ELEMANI	AC150BC-584		<b>MOTOR TRIGER GEAR</b> MOTOR TRIGER DİŞLİSİ
EM145WG-20/D		<b>GUTTER FILTER</b> OLUK SÜZGEÇİ	AC150BC-500		<b>TRIGER BELT</b> TRIGER KAYIŞ T10
EM145WG-30		<b>POST DRANAIGE CAP</b> KOLON TAHLİYE KAPAĞI	AC150BC-591		<b>CONTROL PANEL</b> KONTROL ÜNİTESİ
AC150BC-301		<b>HOLE TEMPLATE</b> DELİK ŞABLONU (150BC-301-00)	AC150BC-592		<b>REMOTE CONTROL</b> KUMANDA
AC150BC-580		<b>TUBULAR MOTOR BRACKET</b> TÜP MOTOR ANKRAJ	AC150BC-593		<b>INSULATED LED (Daylight)</b> İZOLELİ LED (Gün Işığı)
AC150BC-583		<b>OCTAGONAL TUBE</b> SEKİZGEN BORU	AC150BC-594		<b>LED TRANSFORMER</b> LED TRAFOSU

## ACCESSORIES / AKSESUARLAR

PACKAGE CODE PAKET KODU	PICTURE / RESİM	DESCRIPTION AÇIKLAMA
AC150BC-562		<b>LINEER MOTOR BRACKET SET</b> LİNEER MOTOR BRAKET TAKIMI
AC150BC-561		<b>LINEER MOTOR</b> LİNEER MOTOR
AC150BC-701		<b>CORNER COVER SHEET SET</b> KÖŞE KAPAMA LEVHA
AC150BC-702		<b>BACK COVER SHEET SET</b> ARKA KAPAMA LEVHA
EM150BC-201		<b>LAMELLA GASKET</b> LAMEL FİTİLİ
EM150BC-304		<b>MOTOR LAMELLA GASKET</b> MOTOR LAMEL FİTİLİ
EM150BC-403		<b>ISOLATION GASKET</b> İZOLASYON FİTİLİ

ASSEMBLY DETAILS  
MONTAJ DETAYLARI





TUBULER MOTOR MONTAJI & TUP MOTOR MONTAJI

**AC150BC-580**  
TUBULAR MOTOR  
BRACKET  
TUP MOTOR ANKRAJ



**AC150BC-582**  
OCTAGONAL TUBE  
SEKİZGEN BORU



**AC150BC-581**  
TUBULAR MOTOR  
TUP MOTOR



**AC150BC-583**  
TUBE HEAD  
BORU BAŞI



**AC150BC-584**  
MOTOR TRIGER  
GEAR  
MOTOR TRIGER  
DİŞLİSİ

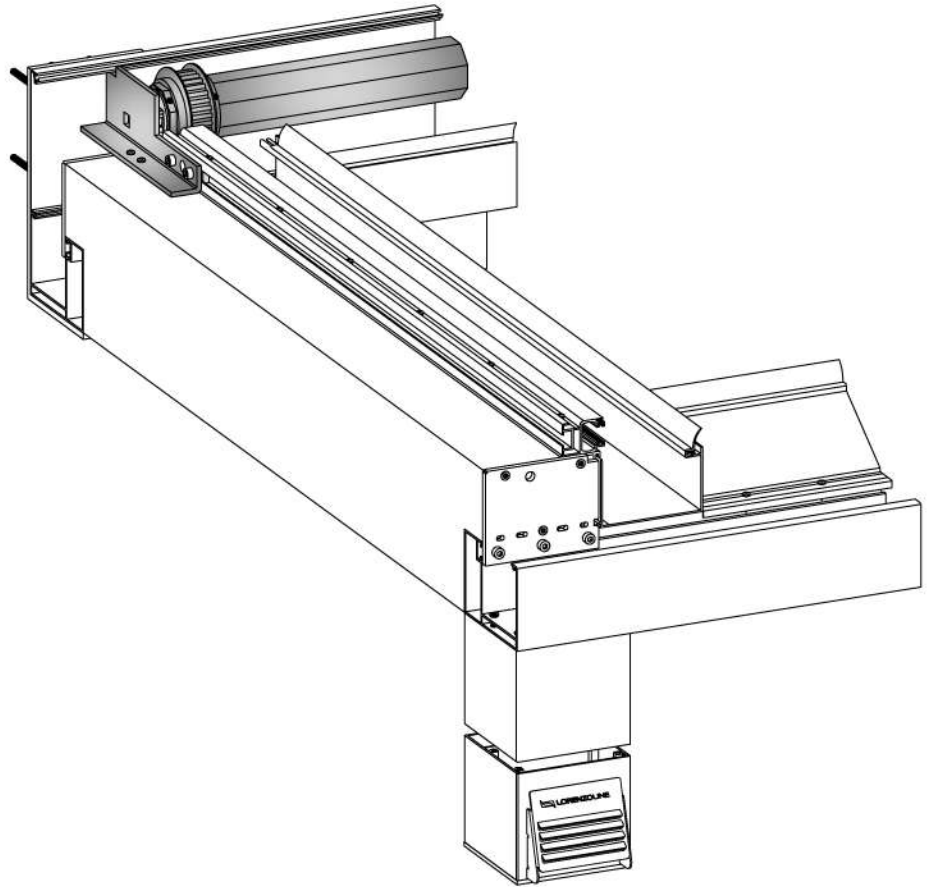

YHB 3.9x9.5  
DIN 7982 - A2  
M5x30 DIN 912  
İmbus Civata  
AC150BC-583

AC150BC-584

AC150BC-582

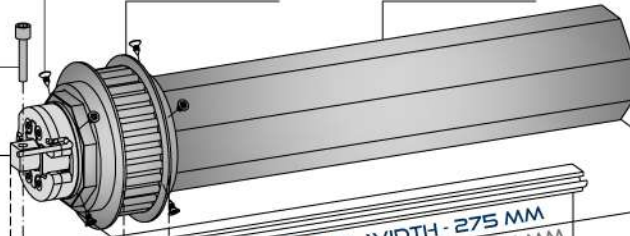

MODUL WIDTH - 275 MM  
MODÜL GENİŞLİĞİ - 275 MM

AC150BC-580

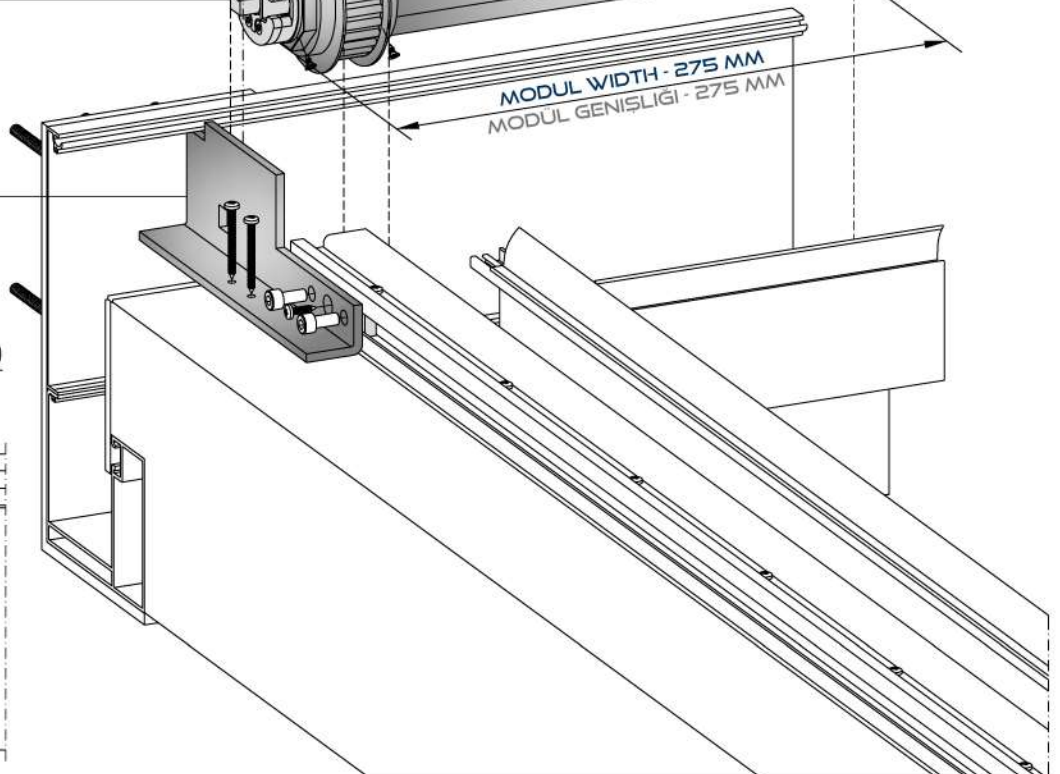

150BC-302-00

AC150BC-580

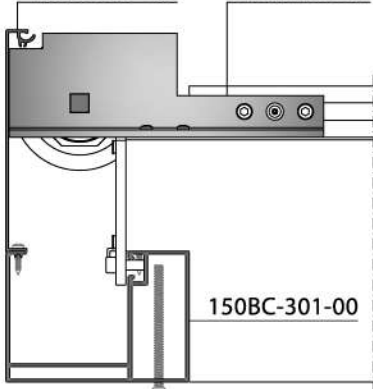

150BC-301-00

**LAMELLAS STEEL SUPPORT MONTAGE**  
LAMEL ÇELİK DESTEK MONTAJI



Steel Box Profile (80x160x6)  
Çelik Kutu Profil  
AC150BC-611

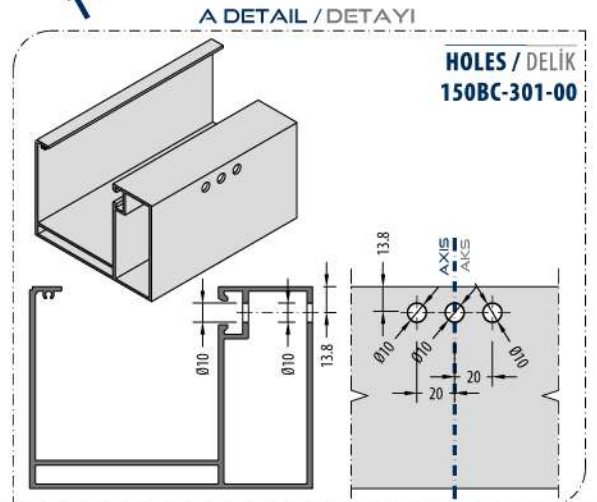
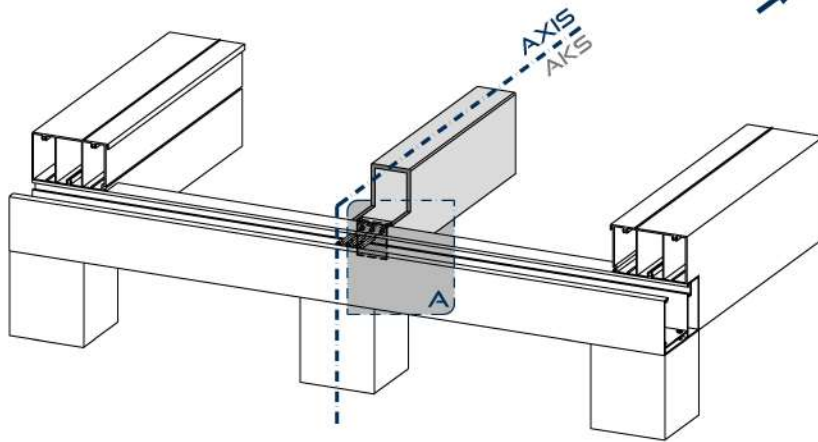
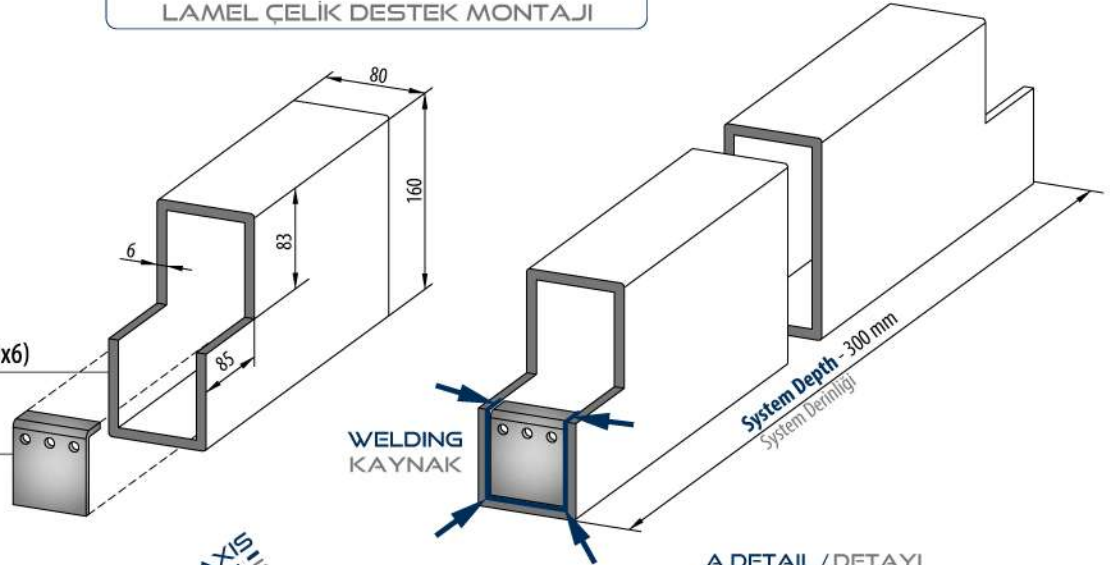

**LAMELLAS SUPPORT WEDGE MONTAGE**  
LAMEL DESTEK TAKOZ MONTAJI

MONTAGE REFERENCE  
MONTAJ REFERANSI

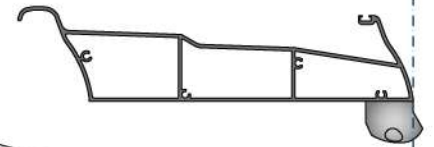
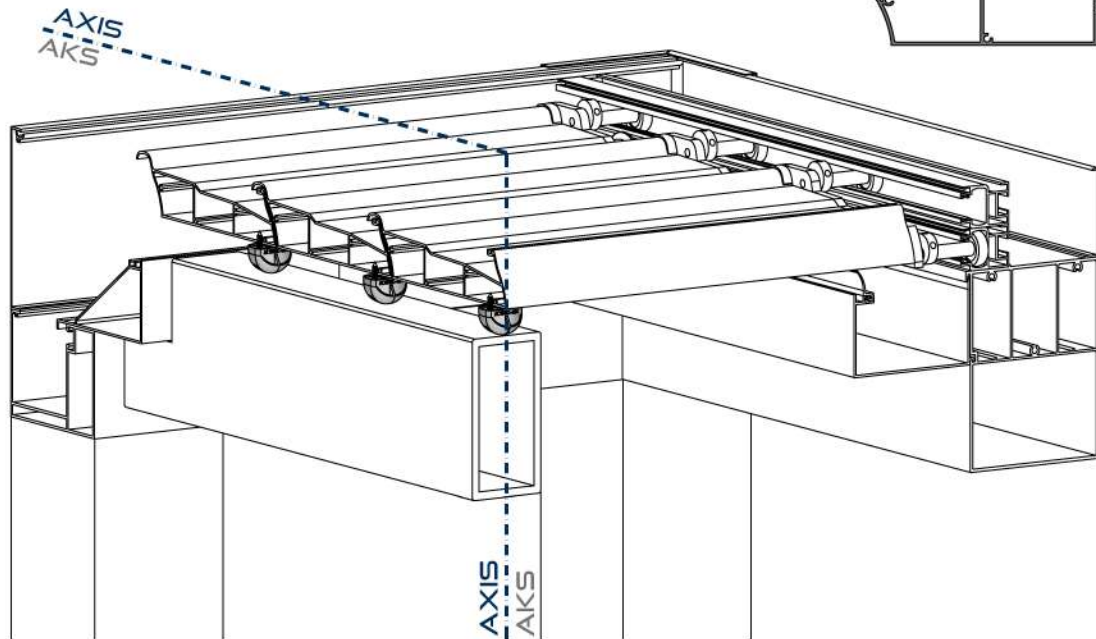

FRONT SIDE  
ÖN TARAF

ENGINE SIDE  
MOTOR TARAFI

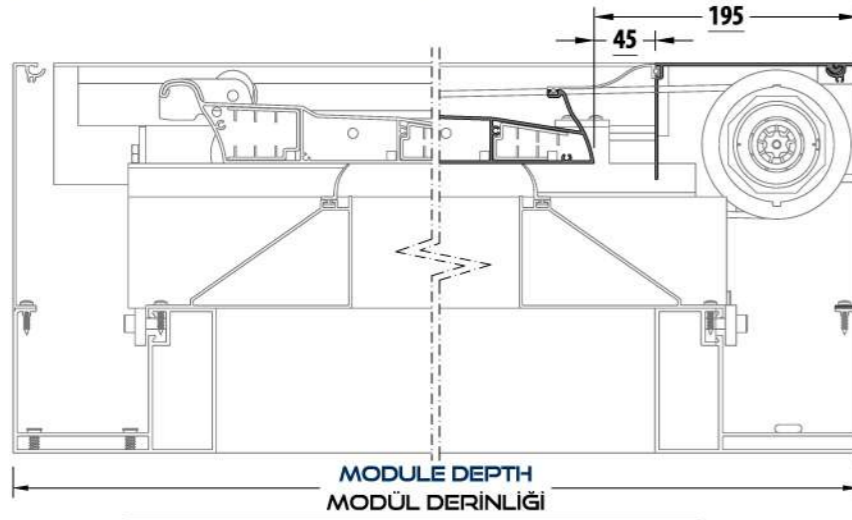

LAMEL START POINT / LAMEL BAŞLANGIÇ  
45 MM

LAMELLAS QUANTITY LAMEL SAYISI	MODULE DEPTH MODÜL DERİNLİĞİ	
3	890	1045
4	1097	1252
5	1304	1459
6	1511	1666
7	1718	1873
8	1925	2080
9	2132	2287
10	2339	2494
11	2546	2701
12	2753	2908
13	2960	3115
14	3167	3322
15	3374	3529
16	3581	3736
17	3788	3943
18	3995	4150
19	4202	4357
20	4409	4564
21	4616	4771
22	4823	4978
23	5030	5185
24	5237	5392
25	5444	5599
26	5651	5806
27	5858	6013
28	6065	6220
29	6272	6427
30	6479	6634
31	6686	6841
32	6893	7048
33	7100	7255
34	7307	7462
35	7514	7669
36	7721	7876
37	7928	8083

**LAMELLA QUANTITY TABLE & LAMEL ADET TABLOSU**

FRONT SIDE  
ÖN TARAF

ENGINE SIDE  
MOTOR TARAFI

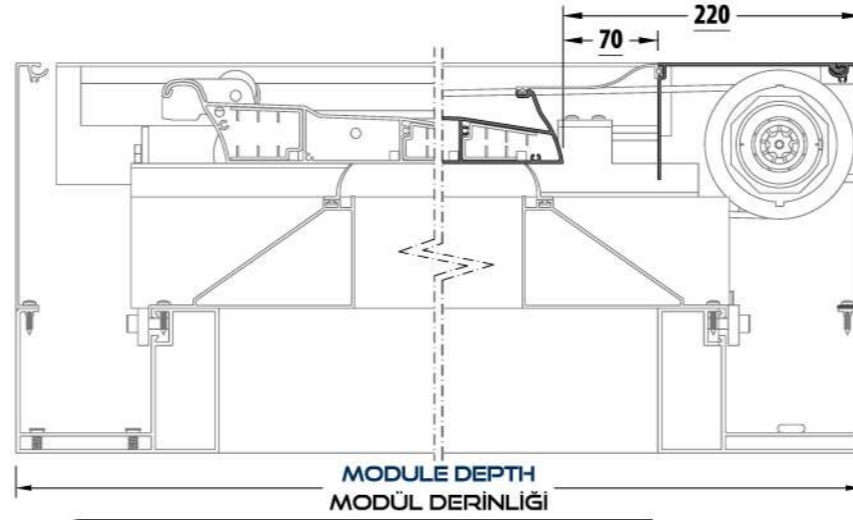

LAMEL START POINT / LAMEL BAŞLANGIÇ  
70 MM

LAMELLAS QUANTITY LAMEL SAYISI	MODULE DEPTH MODÜL DERİNLİĞİ	
3	1046	1070
4	1253	1277
5	1460	1484
6	1667	1691
7	1874	1898
8	2081	2105
9	2288	2312
10	2495	2519
11	2702	2726
12	2909	2933
13	3116	3140
14	3323	3347
15	3530	3554
16	3737	3761
17	3944	3968
18	4151	4175
19	4358	4382
20	4565	4589
21	4772	4796
22	4979	5003
23	5186	5210
24	5393	5417
25	5600	5624
26	5807	5831
27	6014	6038
28	6221	6245
29	6428	6452
30	6635	6659
31	6842	6866
32	7049	7073
33	7256	7280
34	7463	7487
35	7670	7694
36	7877	7901
37	8084	8108

FRONT SIDE  
ÖN TARAF

ENGINE SIDE  
MOTOR TARAFI

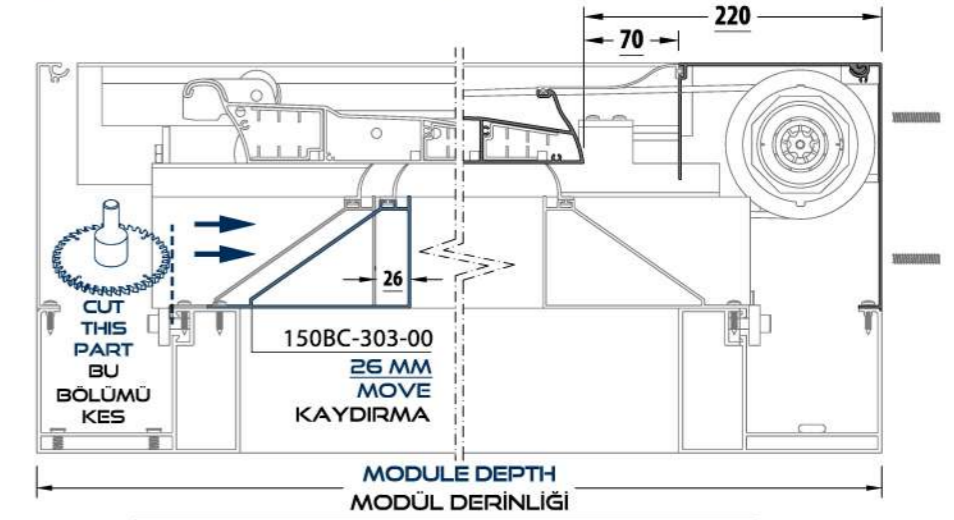

LAMEL START POINT  
70 MM  
LAMEL BAŞLANGIÇ + MOVING "150BC-303-00"  
YERİNİN DEĞİŞTİRİLMESİ

LAMELLAS QUANTITY LAMEL SAYISI	MODULE DEPTH MODÜL DERİNLİĞİ	
3	1071	1096
4	1278	1303
5	1485	1510
6	1692	1717
7	1899	1924
8	2106	2131
9	2313	2338
10	2520	2545
11	2727	2752
12	2934	2959
13	3141	3166
14	3348	3373
15	3555	3580
16	3762	3787
17	3969	3994
18	4176	4201
19	4383	4408
20	4590	4615
21	4797	4822
22	5004	5029
23	5211	5236
24	5418	5443
25	5625	5650
26	5832	5857
27	6039	6064
28	6246	6271
29	6453	6478
30	6660	6685
31	6867	6892
32	7074	7099
33	7281	7306
34	7488	7513
35	7695	7720
36	7902	7927
37	8109	-

FRICION MONTAGE & MAKAS MONTAJI

**AC150BC-221**

FRICION HINGE  
BIOCLIMATIC  
MAKAS BİOKLİMATİK

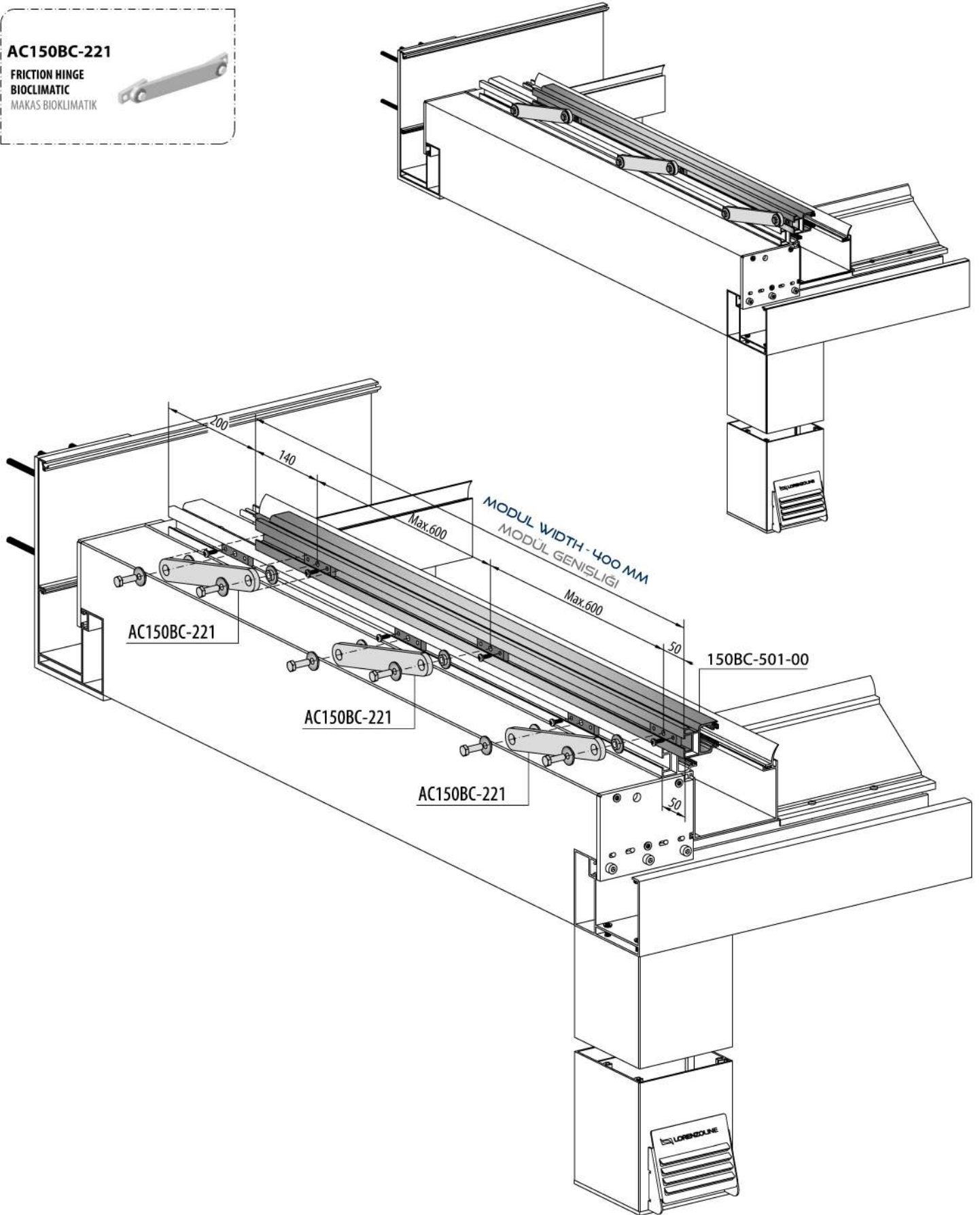

LAMELLA MONTAGE & LAMEL MONTAJI



ALUMINIUM LAMELLA / ALÜMİNYUM LAMEL

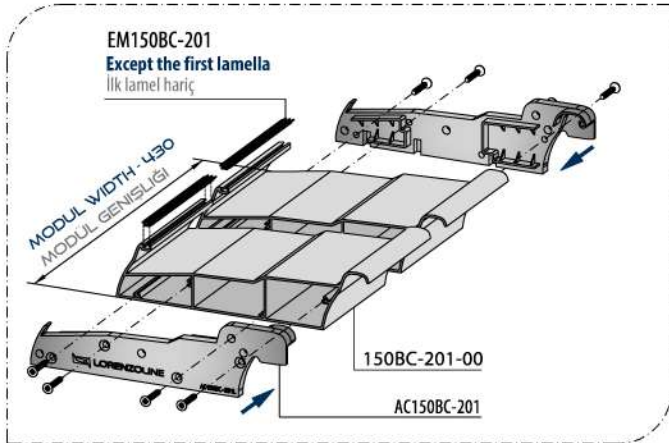

GLASS LAMELLA / CAM LAMEL

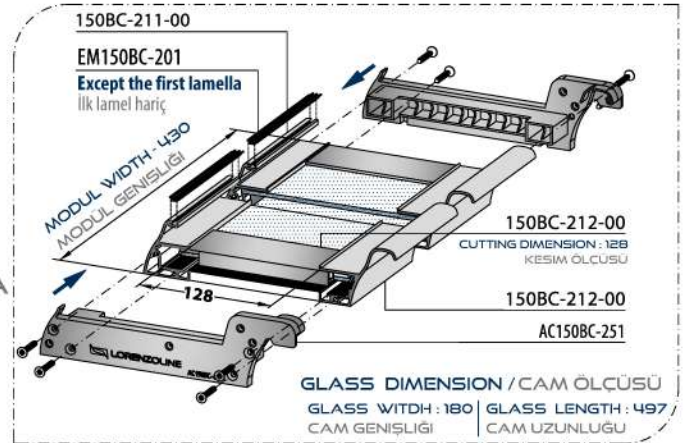

LAMELLA MONTAGE / LAMEL MONTAJI

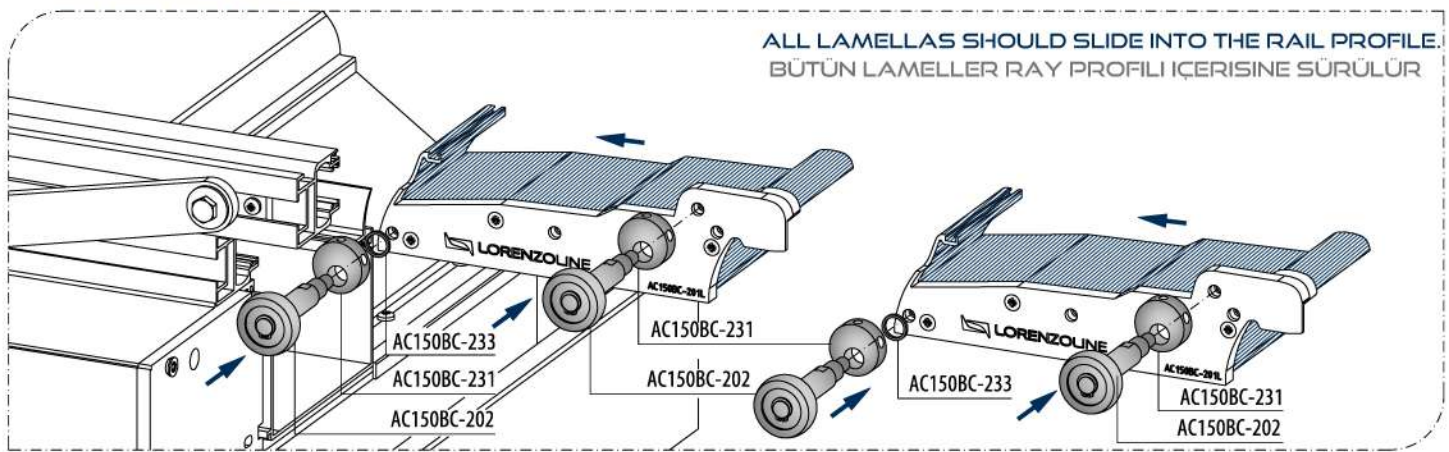

LAMELLA LOCK SET / LAMEL KITLEME MONTAJI

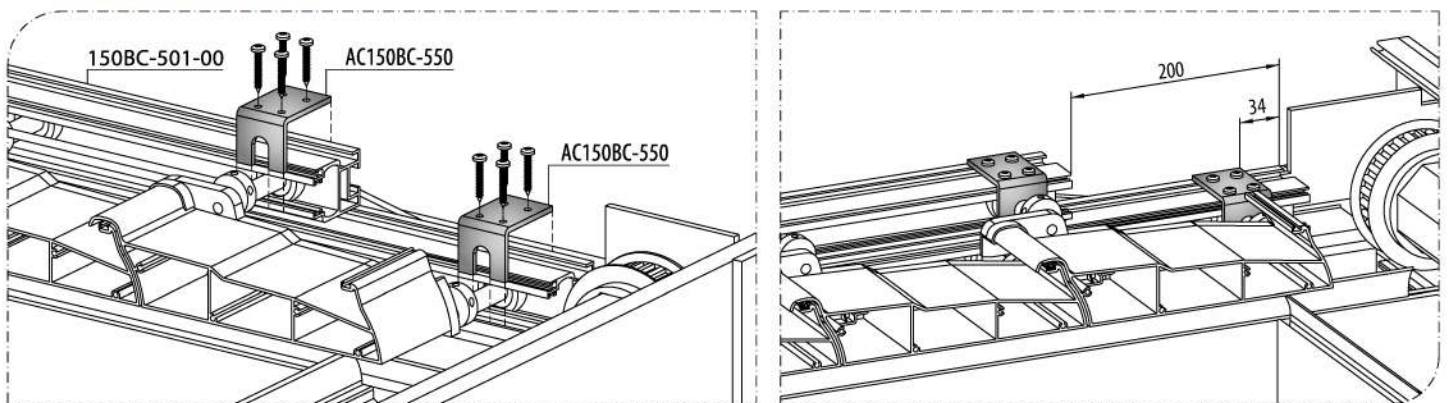

TRIGER BELT MONTAGE & TRIGER KAYIŞ MONTAJI

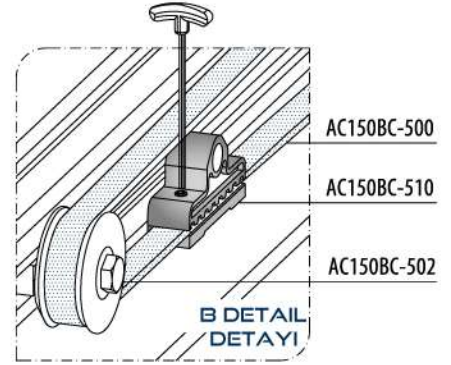
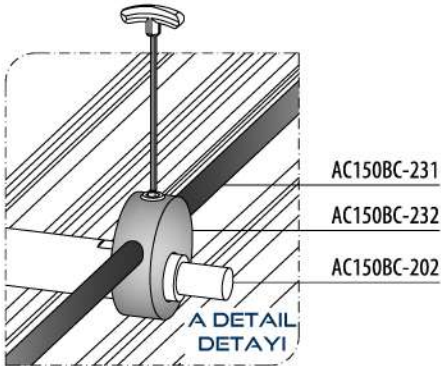
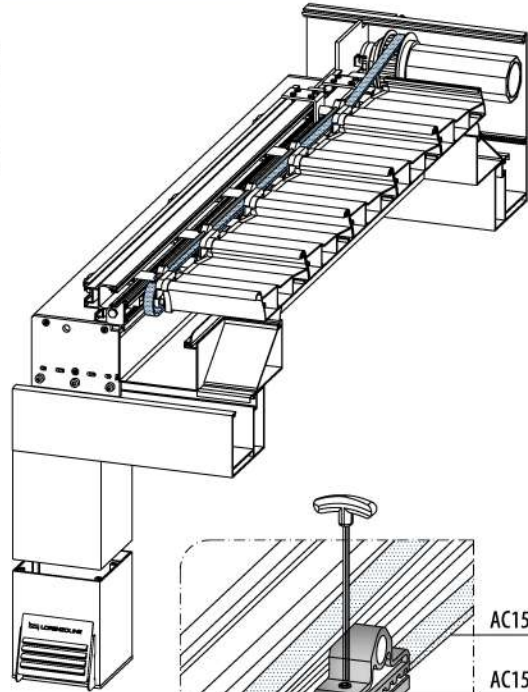

The stainless rope should be fixed when distance between the lamellas is correctly adjusted.  
Lameller arası mesafesi doğru şekilde ayarlandıktan sonra halat sabitlemesi yapılır.

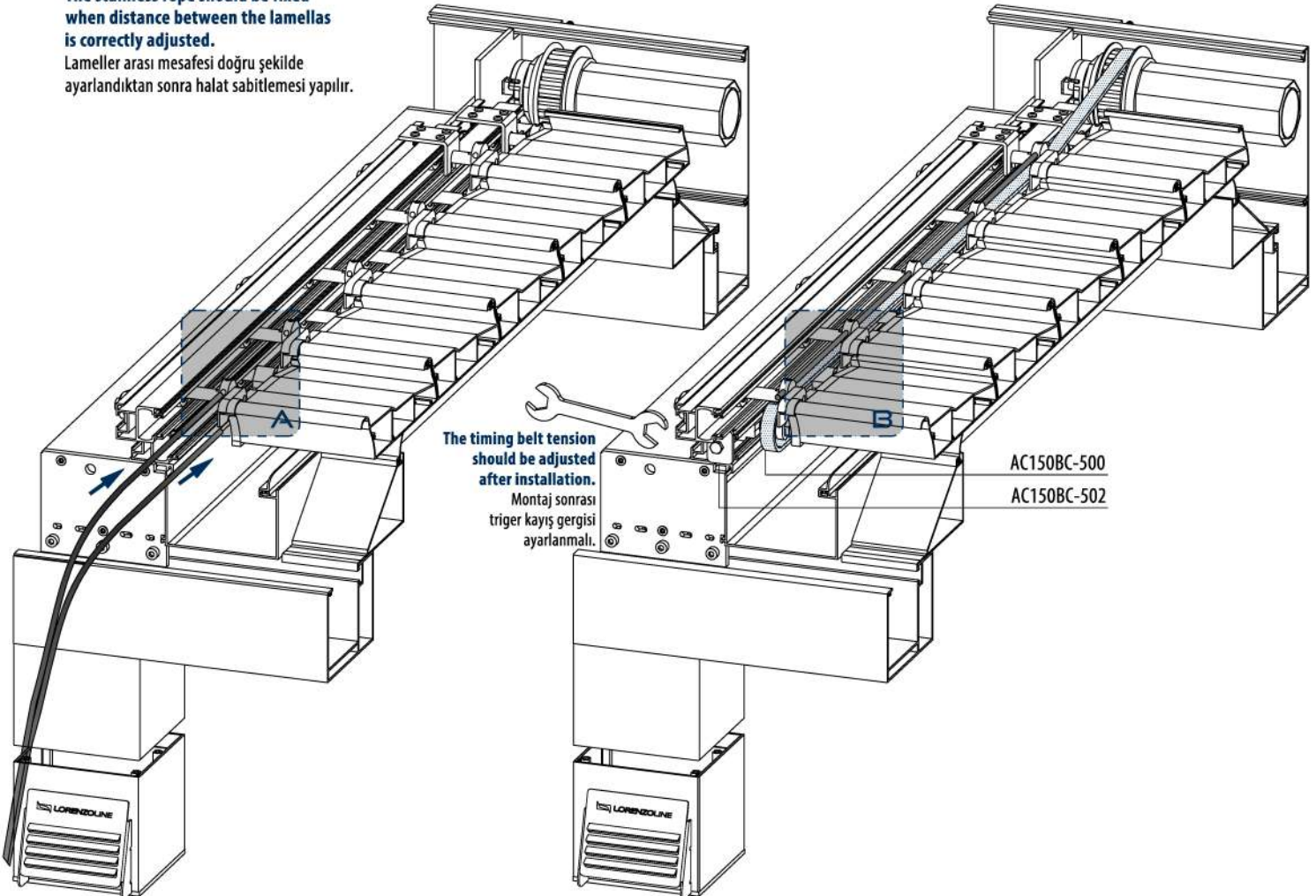

**FINISHING COVER MONTAGE & BİTİŞ KAPAMA MONTAJI**

- AC150BC-701**  
CORNER COVER SHEET SET  
KÖŞE KAPAMA LEVHA
- AC150BC-702**  
BACK COVER SHEET SET  
ARKA KAPAMA LEVHA
- AC150BC-561**  
LINEER MOTOR  
LINEER MOTOR
- AC150BC-562**  
LINEER MOTOR BRACKET SET  
LINEER MOTOR BRAKET TAKIMI

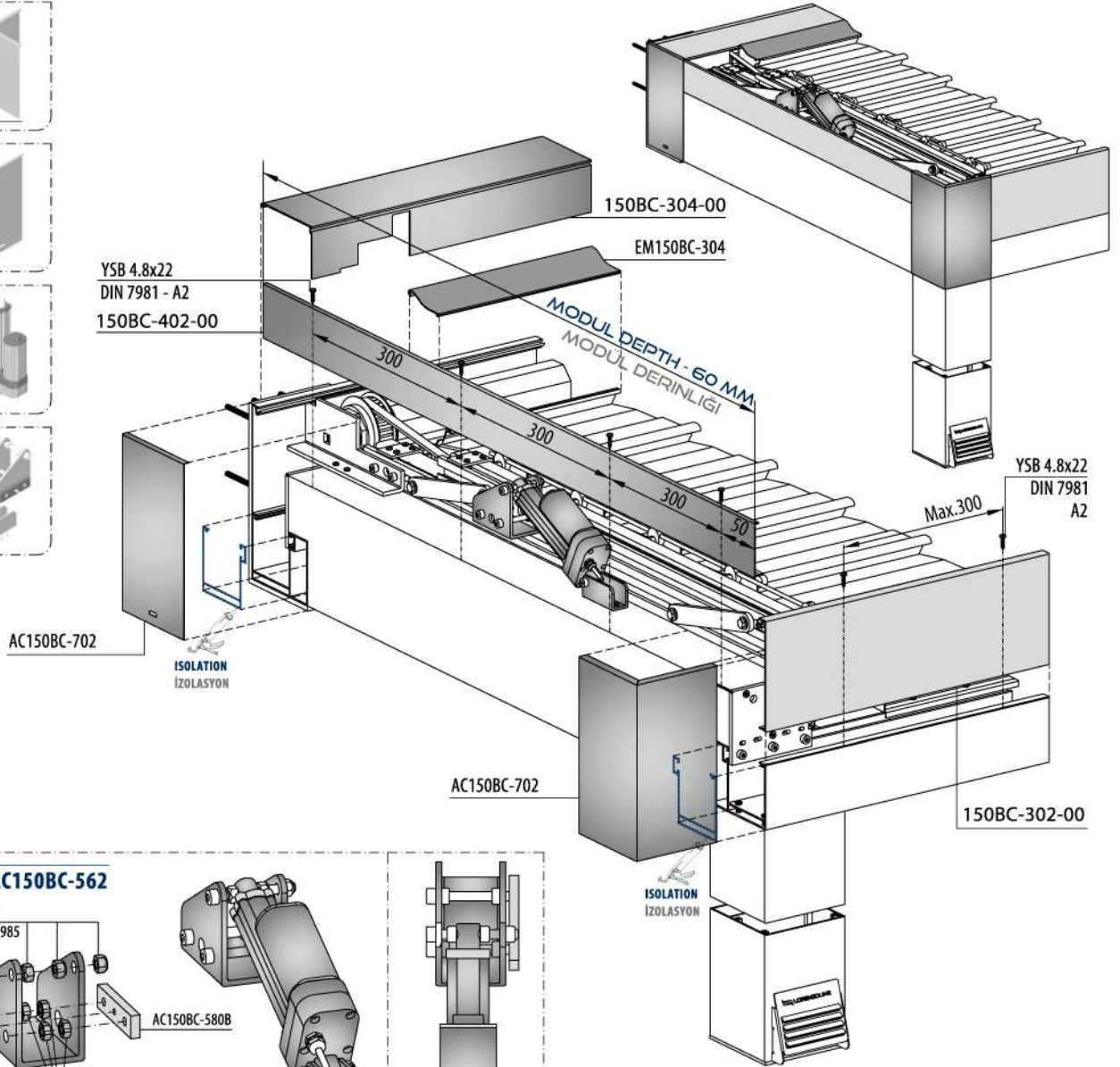

**AC150BC-561 & AC150BC-562**

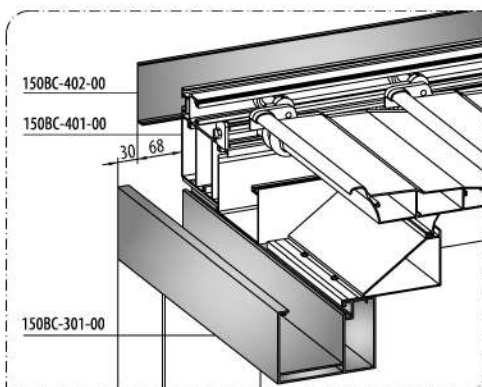
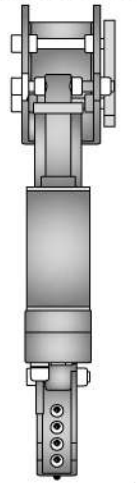
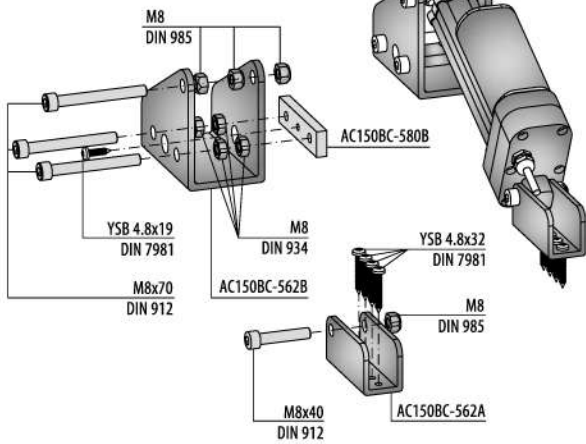

**NOTCH / KERTME**  
**150BC-304-00**

